

SUPERIOR

MAMPARA DE DUCHA

ANGULAR 3 HOJAS:
1 CORREDERA + 2 FIJOS

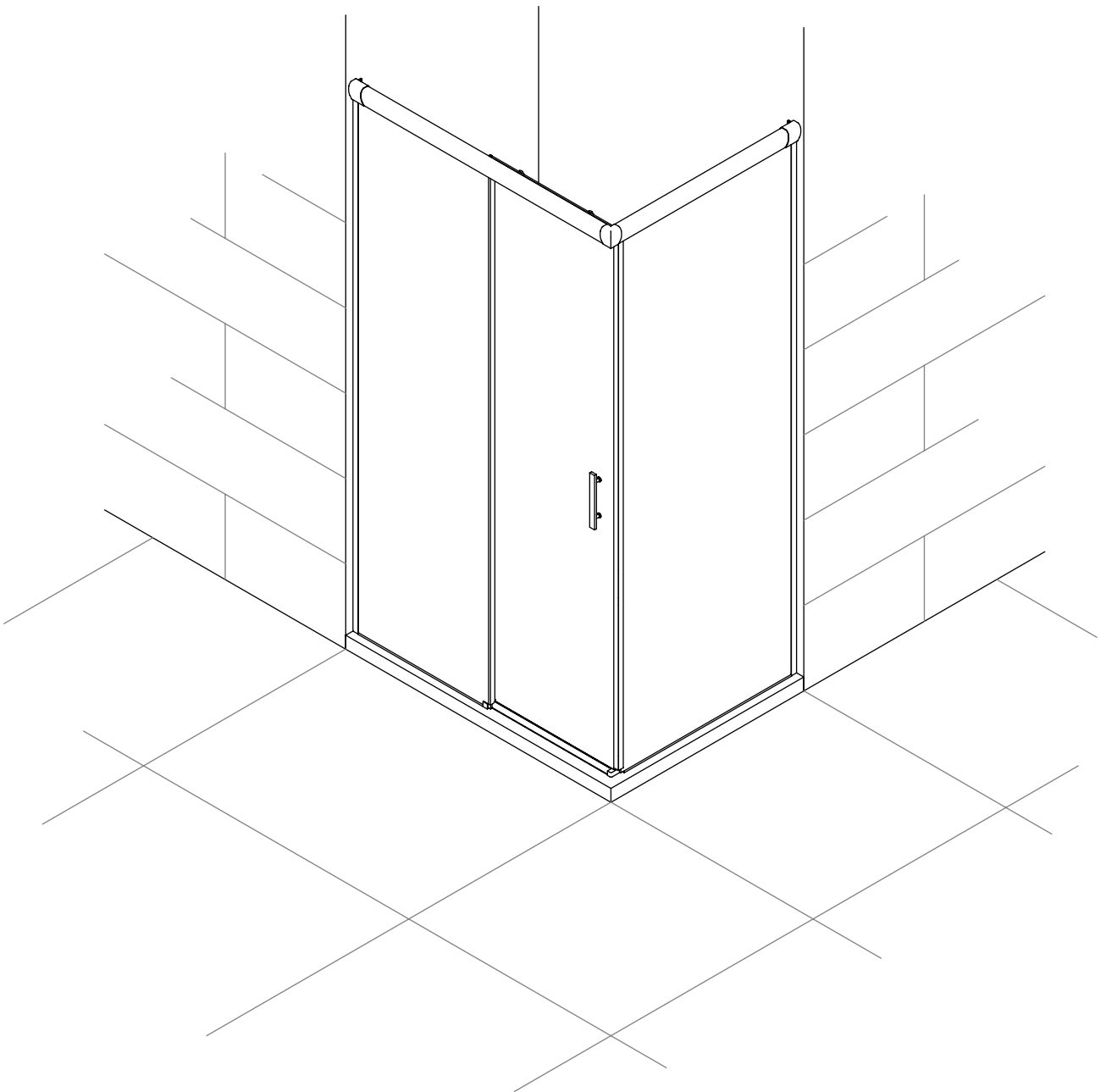

1

presentar "U" en pared
y marcar taladros

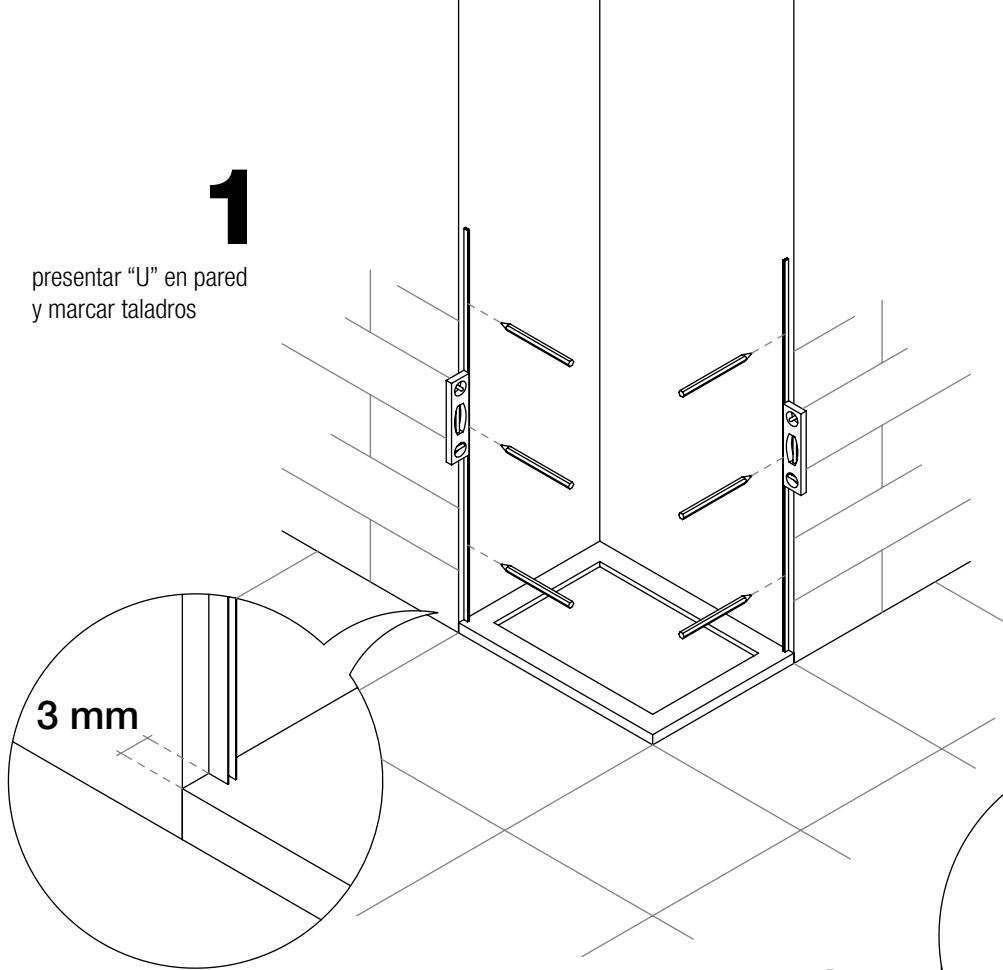

3 mm

2

taladrar con
broca de Ø 5mm

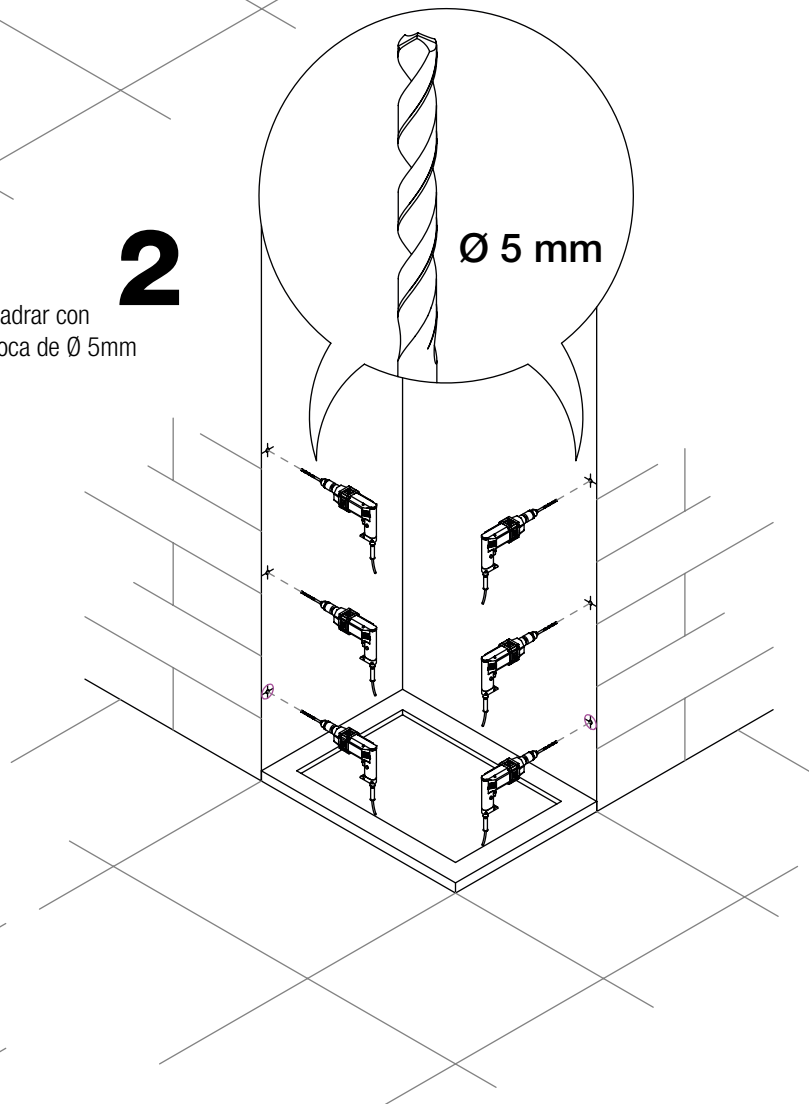

Ø 5 mm

3

atornillar la "U" a pared usando
tacos del nº5 y tornillos 3 x 30
en cada lateral

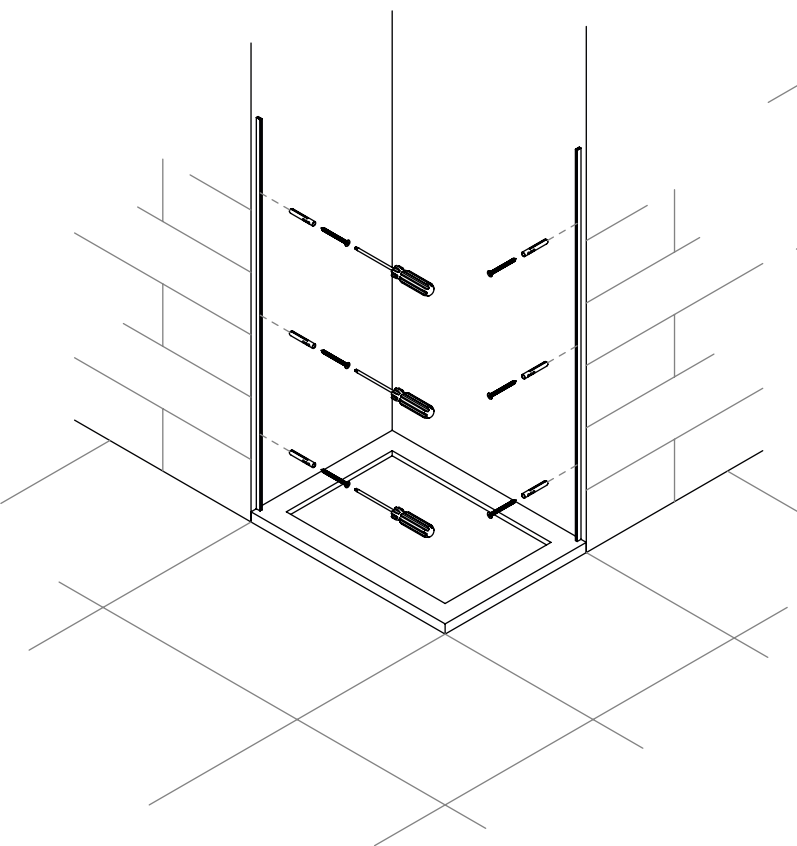

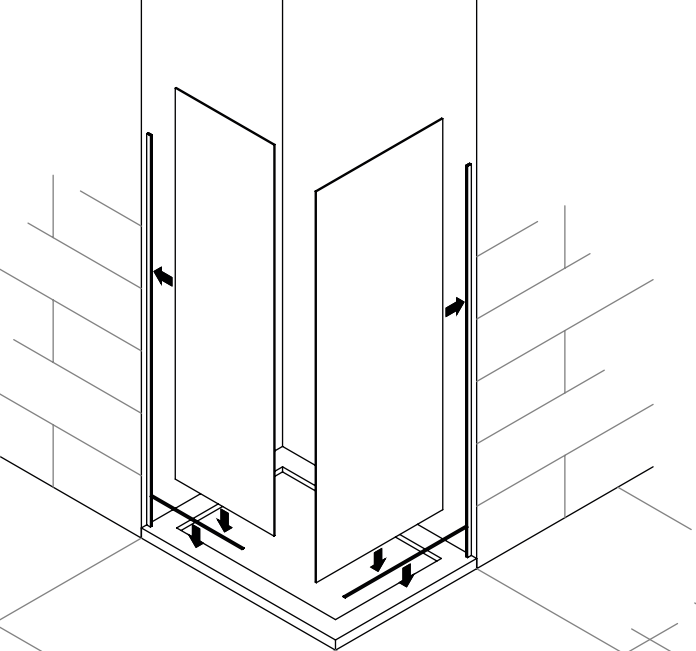

4

colocar miniburbujas adhesivas en el plato e introducir los 2 cristales fijos en cada "U" apoyandolo sobre éstas.

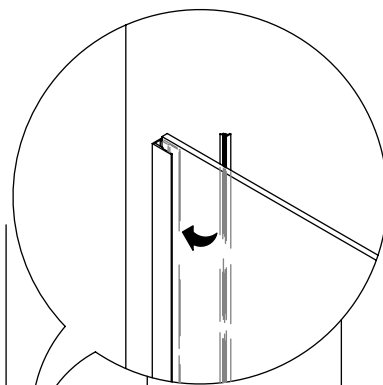

engomar cristal fijo y "U" y colocar la pinza baja en el extremo del vidrio

5

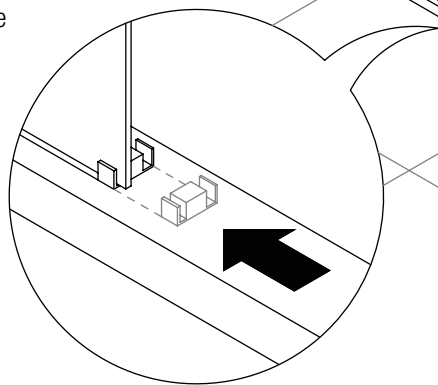

6

unir las dos guías mediante el codo, fijandolas a través de los tornillos autorroscantes

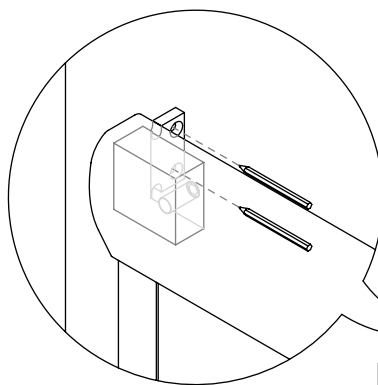

7

presentar guía superior sobre el vidrio fijo, nivelar y marcar los taladros

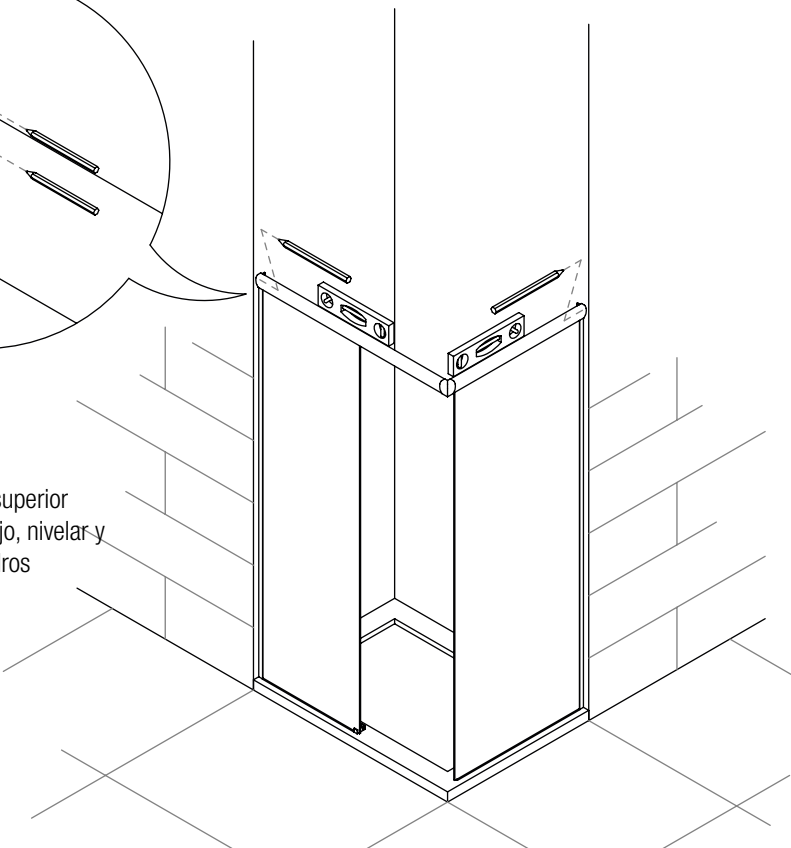
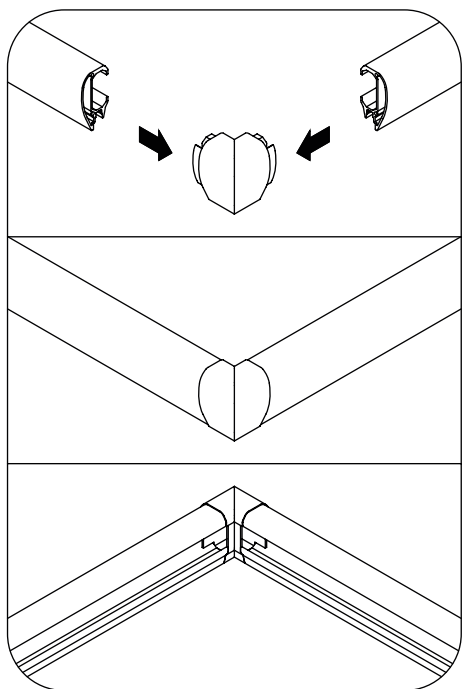

8

taladrar con broca de Ø 6mm

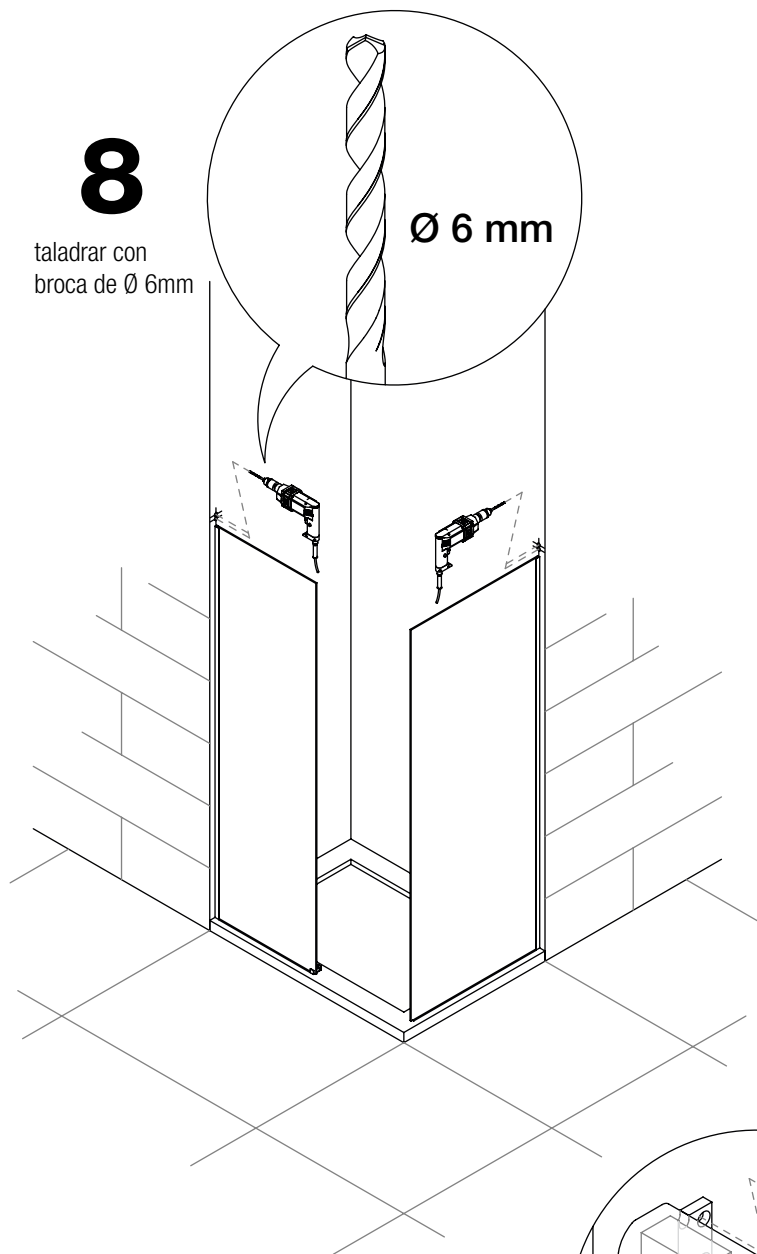

9

echar unos puntos de silicona en la parte inferior de la guía, en el tramo donde va el fijo

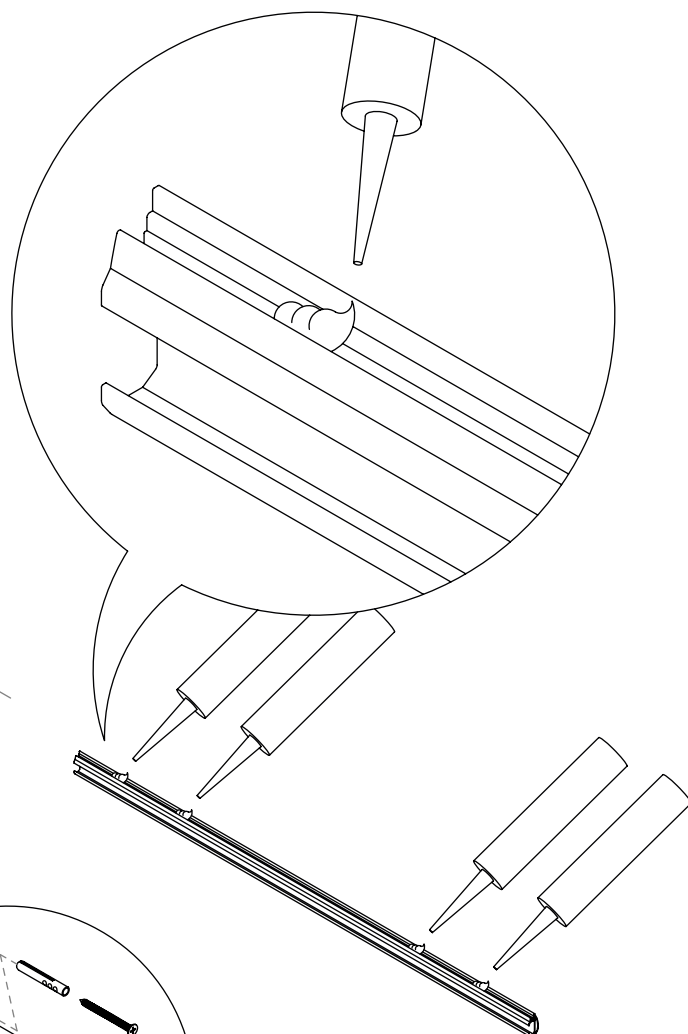

10

introducir en las guías los rodamientos y los topes

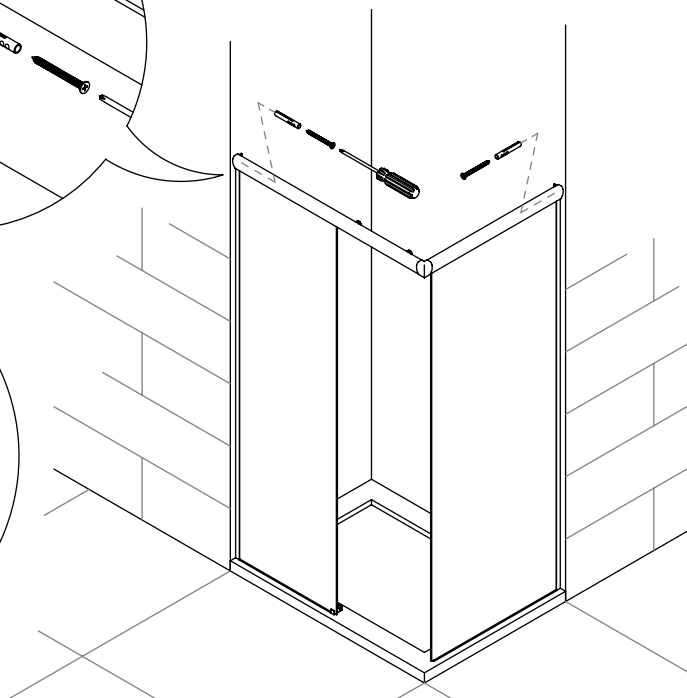
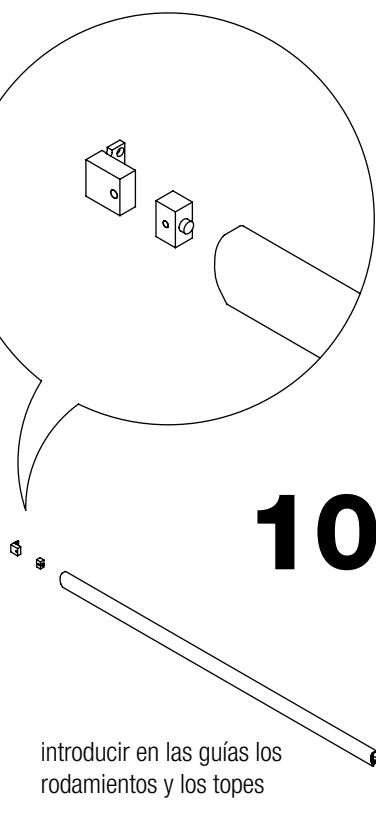
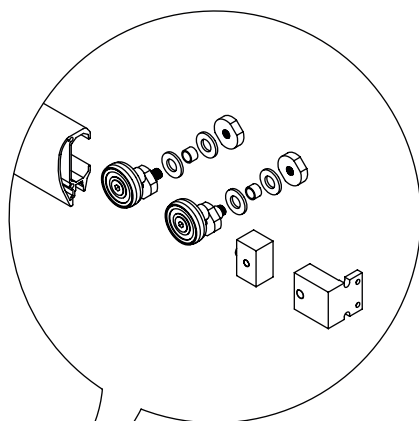
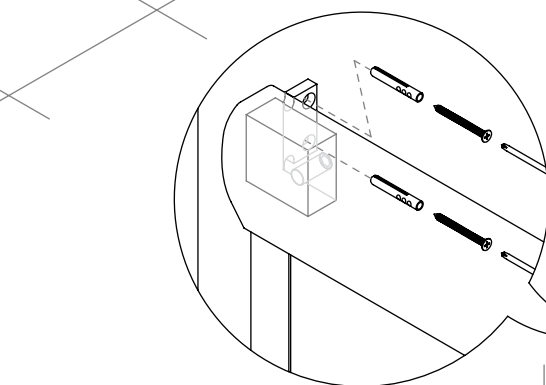

atornillar la guía superior por medio de las cogidas a pared

11

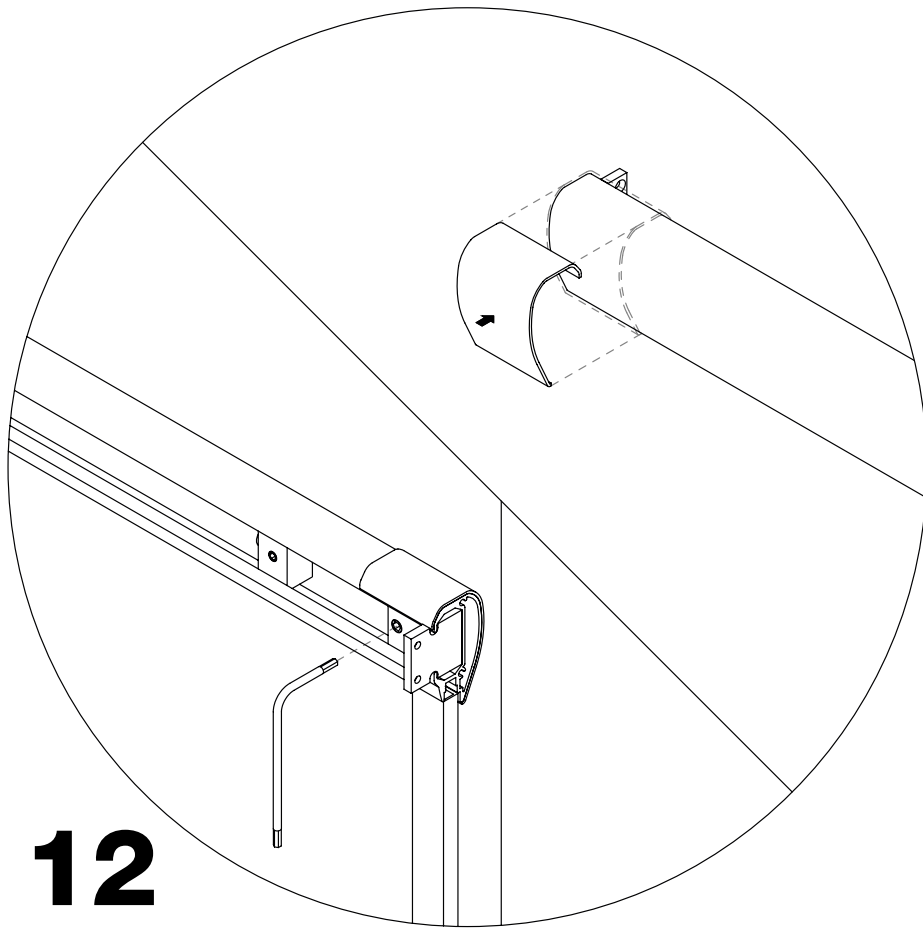

12

fijar las cogidas a la guía mediante los prisioneros y colocar los embellecedores

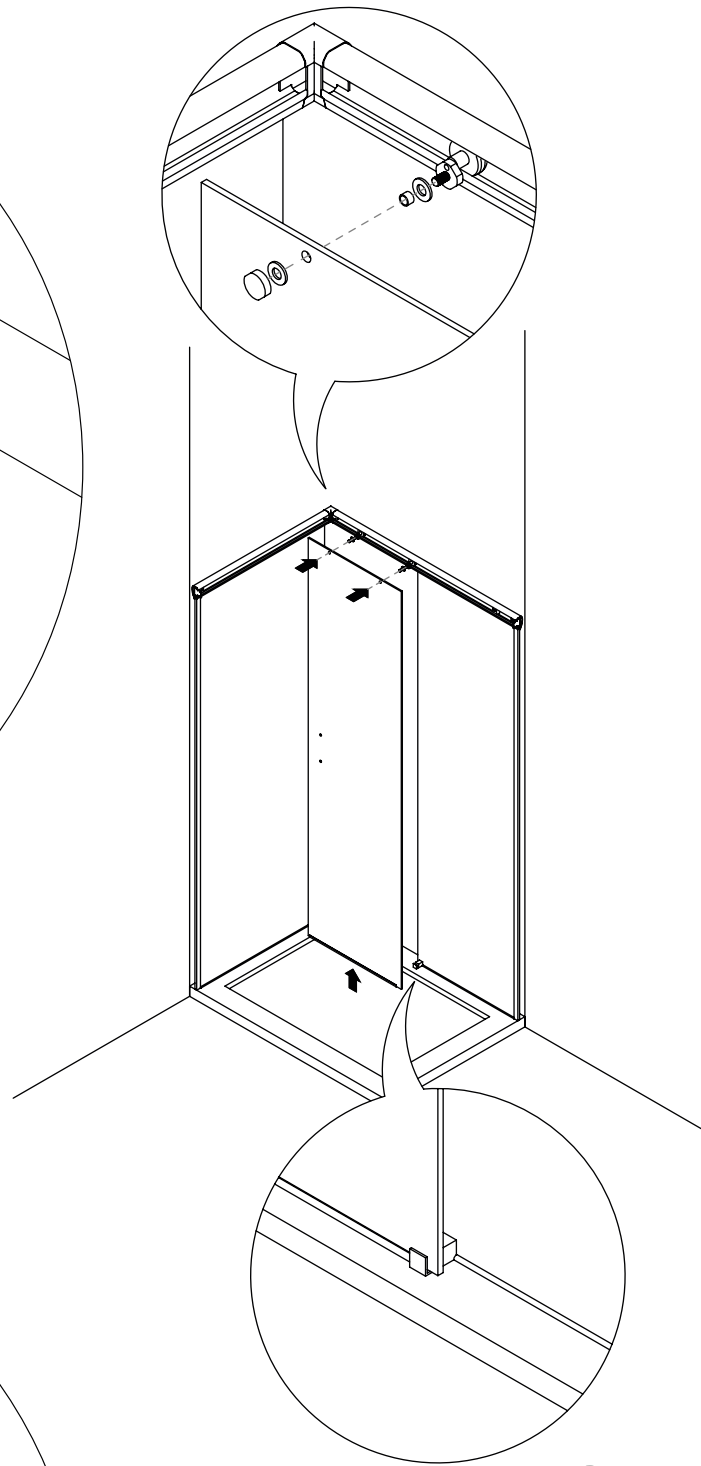

13

colocar la hoja fija en los rodamientos introduciendo previamente la goma "U" en el canto inferior e insertandolo por la ranura más ancha de la pinza inferior

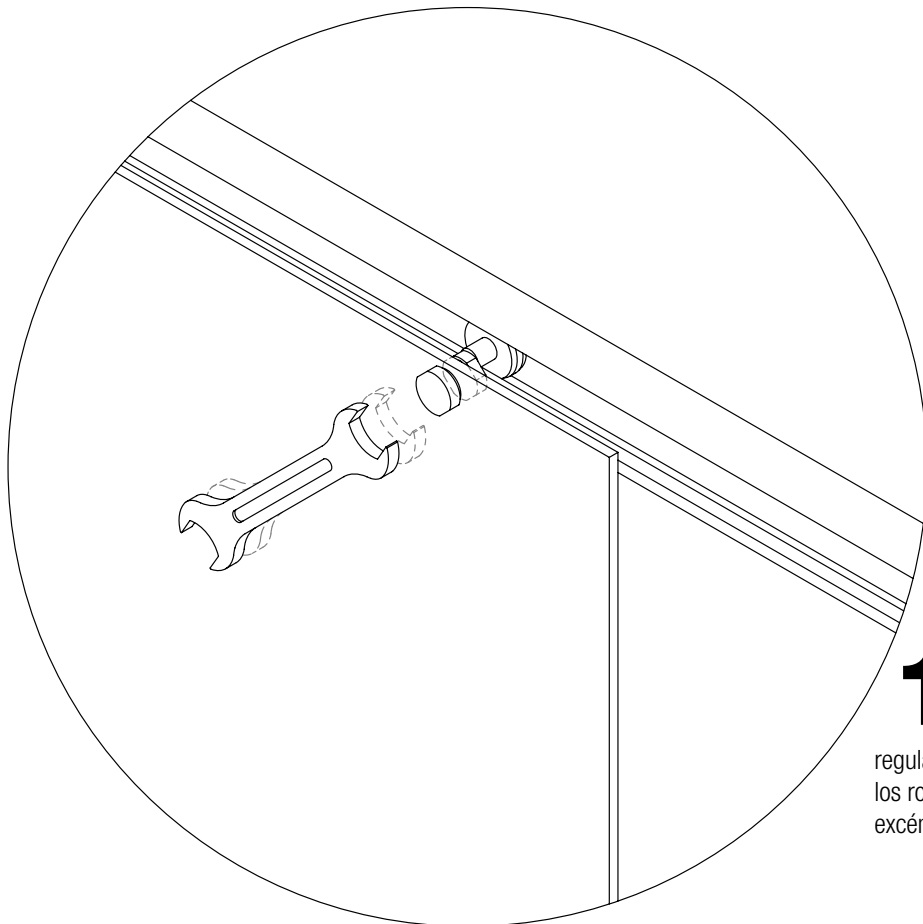

14

regular la hoja mediante los rodamientos excéntricos con 2 llaves

14

colocar las gomas de cruce, una en cada fijo y 2 en la hoja corredera.
colocar el tirador

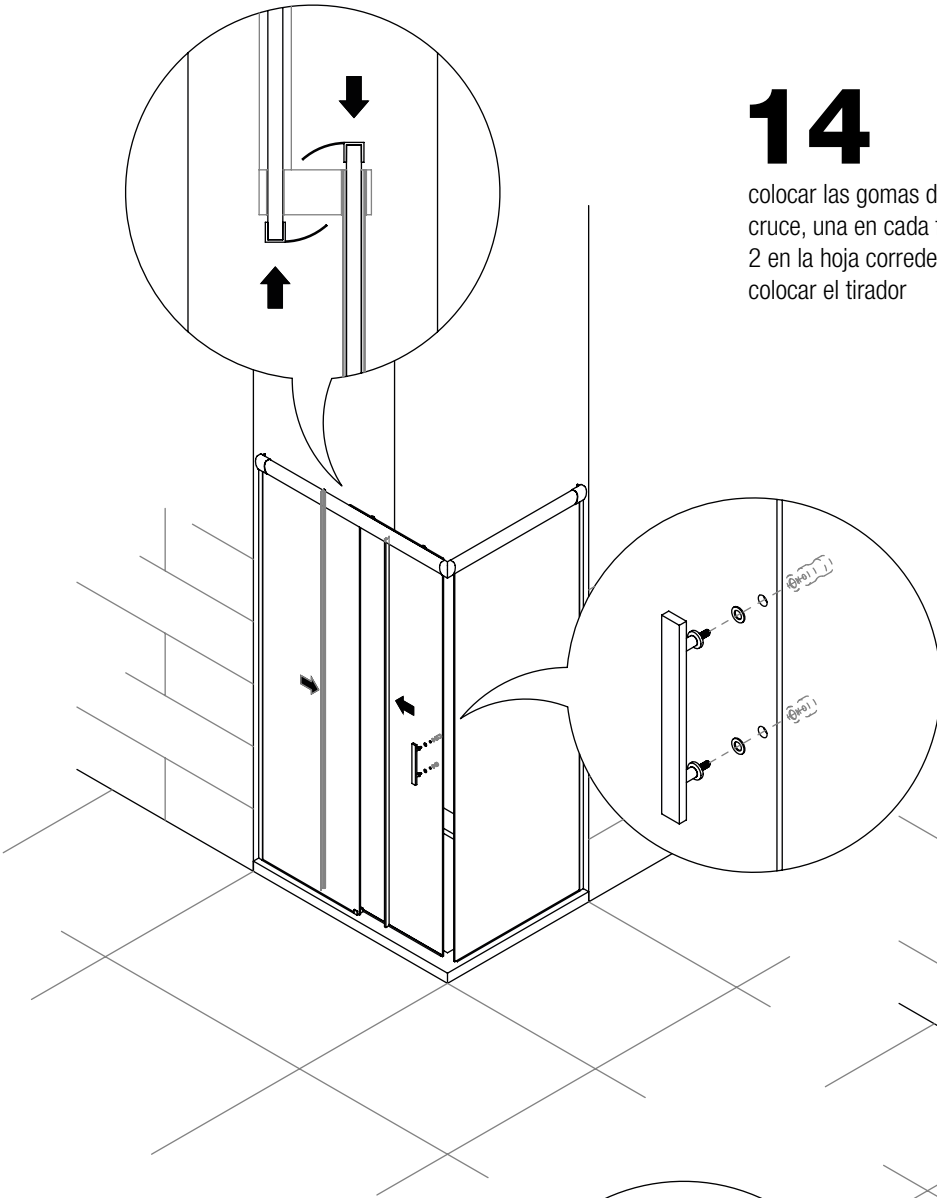

colocar el cierre de imán, en el extremo de la hoja corredera y el panel lateral fijo

15

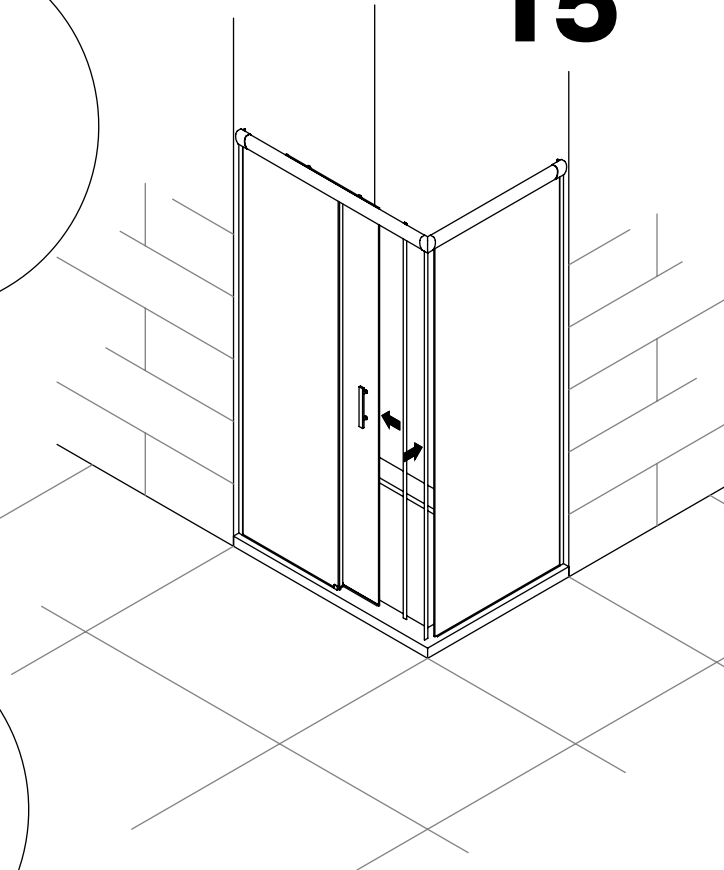

fijar los topes mediante el prisionero

16

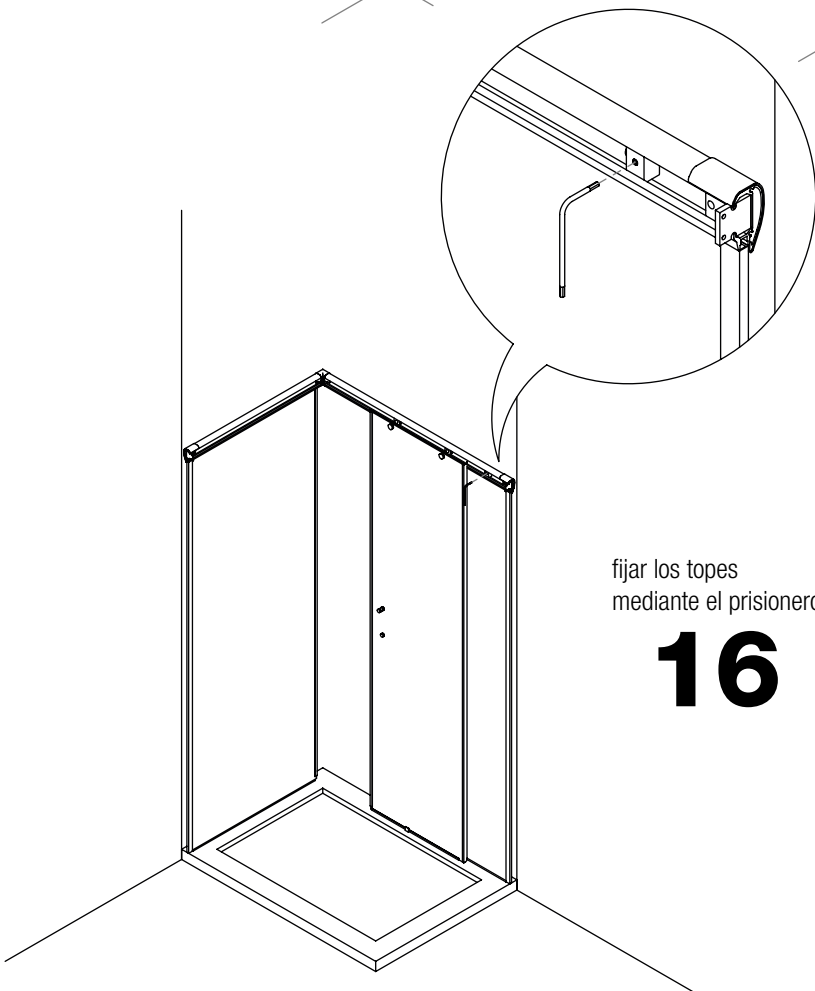

cortar el perfil bajo a medida, desde la pinza baja hasta el otro cristal fijo, colocandole el embellecedor y situar por delante de la hoja corredera

17

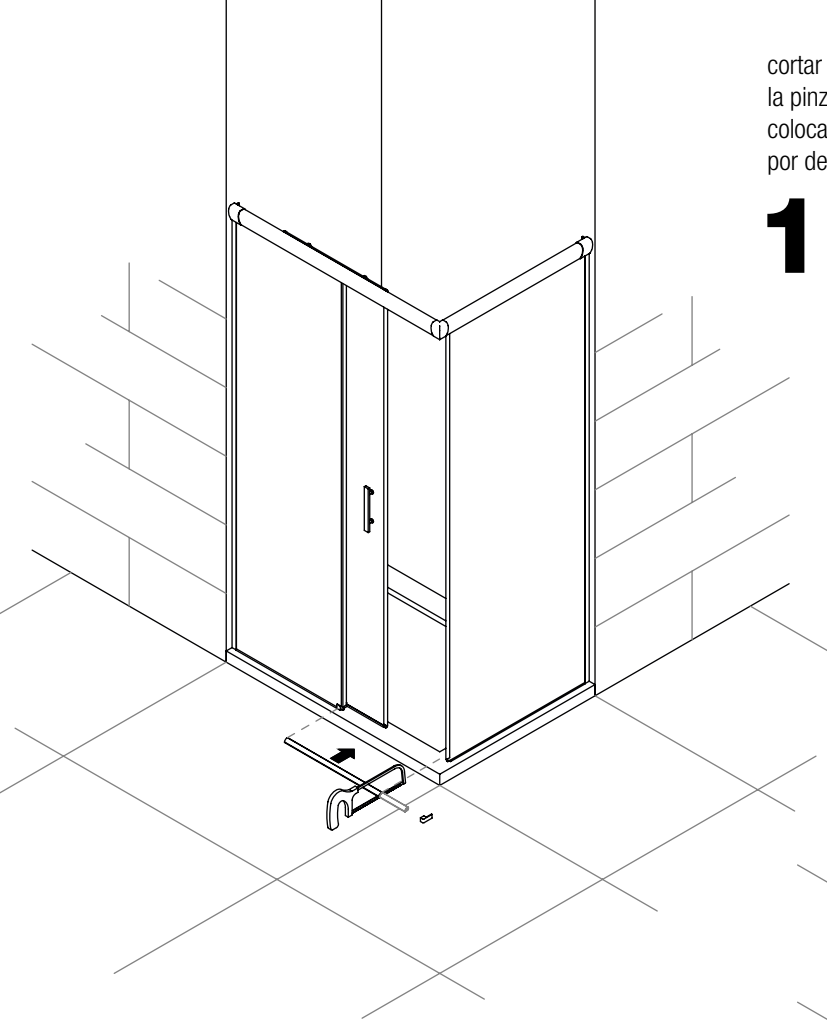

18

sellar perfil bajo con silicona, por delante y por detrás

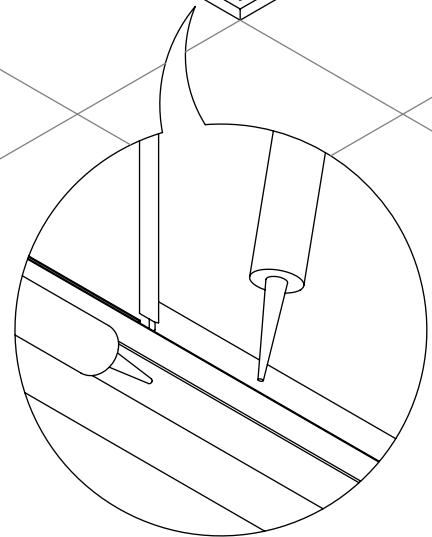
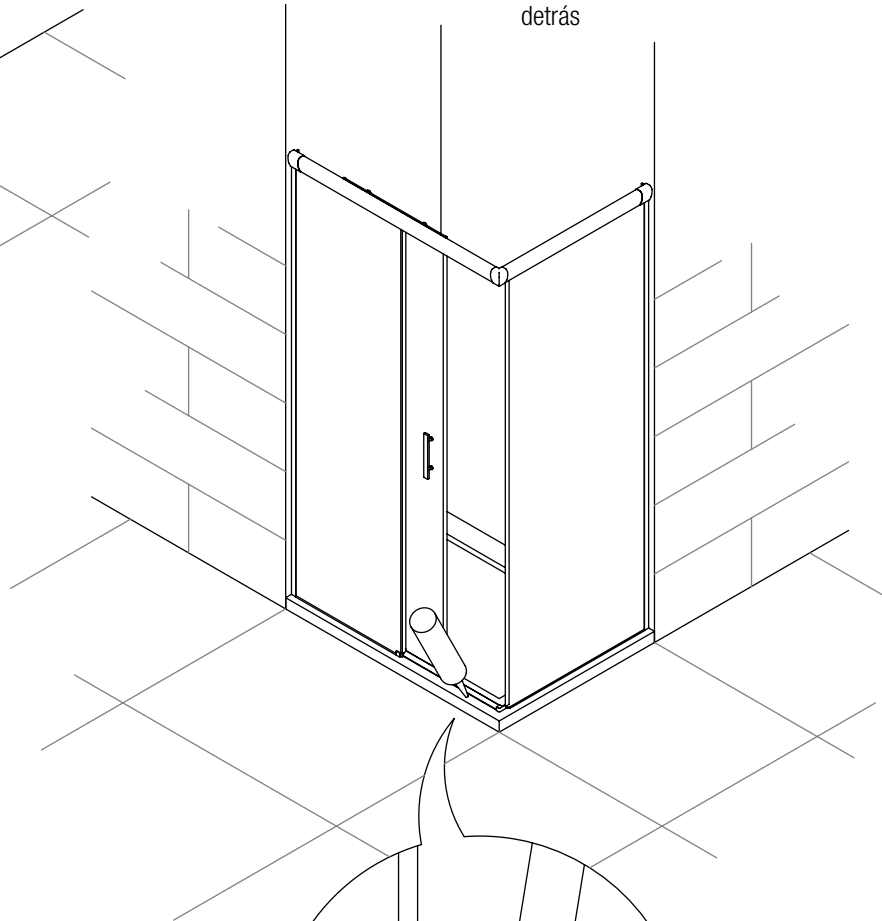

19

sellar con silicona el contorno interior de la mampara

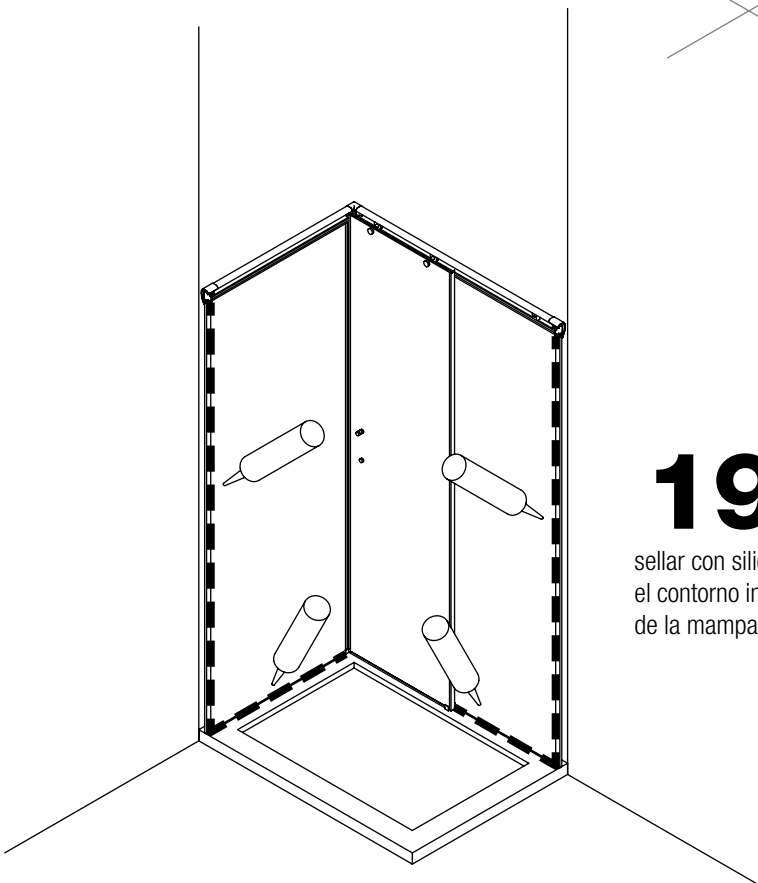

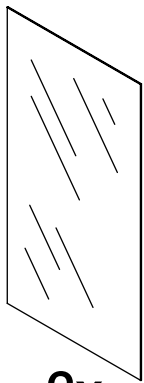
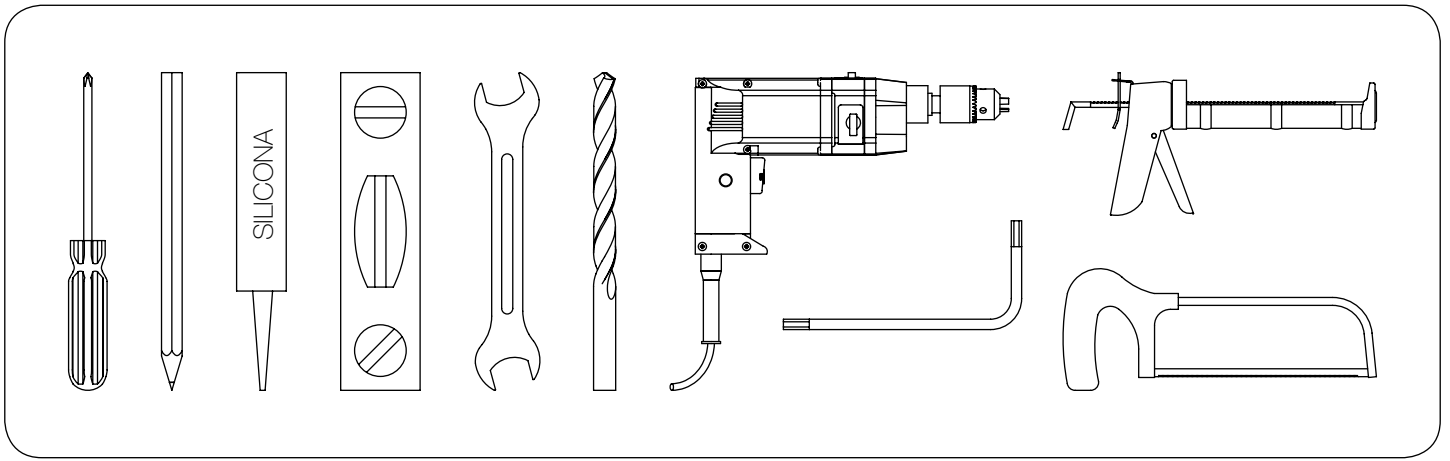

2x
vidrio hoja fija

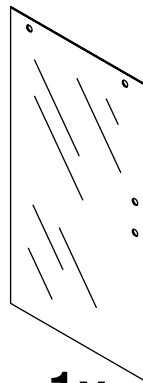

1x
vidrio hoja corredera

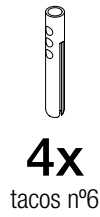

4x
tacos nº6



6x
tacos nº5

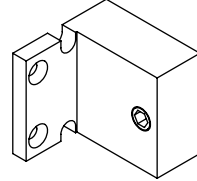

2x
cogidas a pared / guía

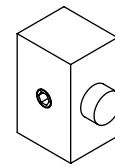

1x
tope interior guía

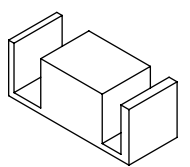

1x
pinza guía inferior

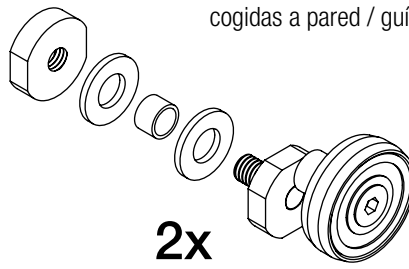

2x
rodamientos de acero inoxidable

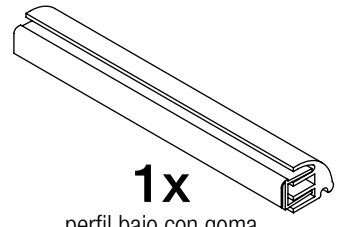

1x
perfil bajo con goma

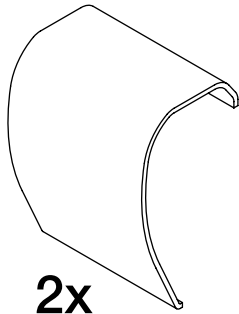

2x
embellecedores guía

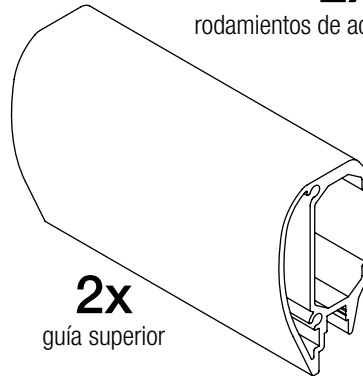

2x
guía superior

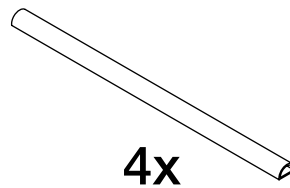

4x
miniburbujas inferior hoja fija

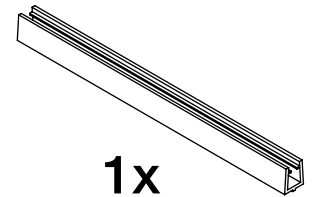

1x
goma "U" inferior hoja corredera

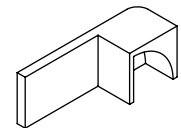

1x
embellecedor perfil bajo

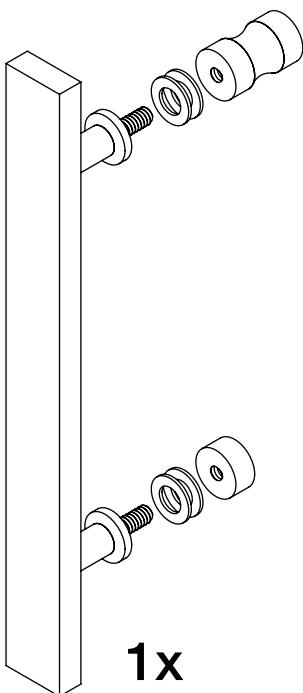

1x
tirador

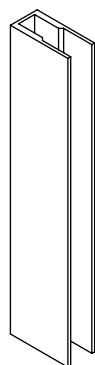

2x
"U" para fijo

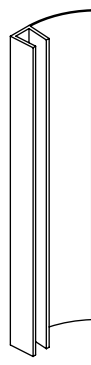

2x
gomas de cruce fijo / corredera



2x
goma fijo / "U"

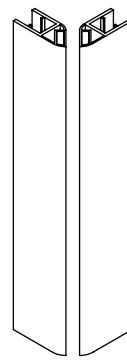

1x
cirrede de imán



2x
tornillo autorroscante



4x
tornillo 4,2 x 32



6x
tornillo 3 x 30

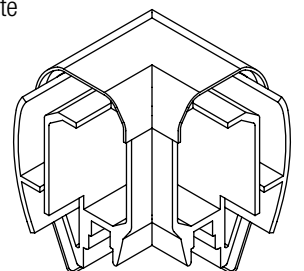

1x
codo unión guía

instrucciones realizadas por:



www.ar3d.es