

ATLÁNTICO

MAMPARA DE DUCHA

FRONTAL 4 HOJAS:
2 CORREDERAS + 2 FIJOS

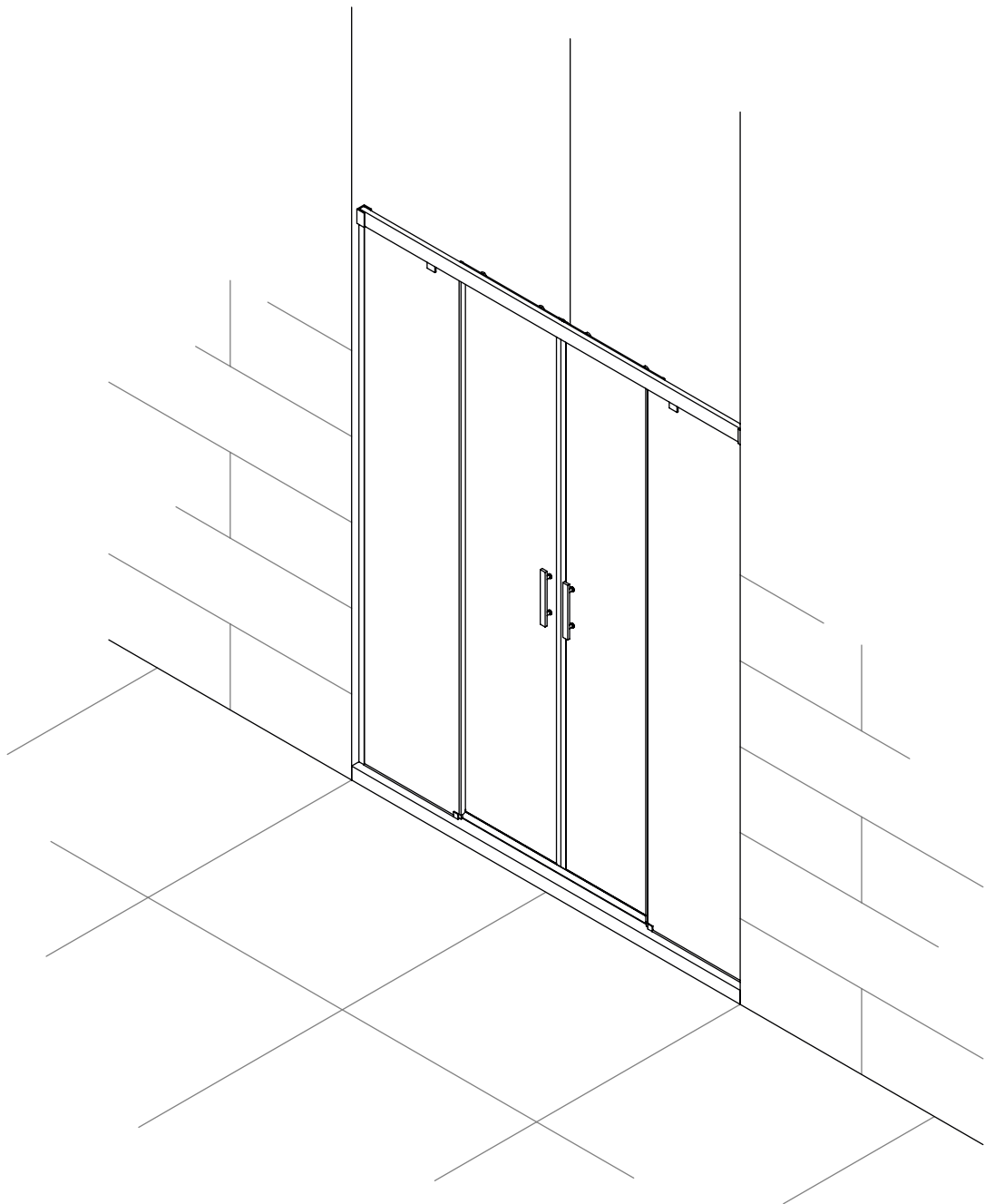

1

presentar "U" en pared
y marcar taladros
* (proceder igual en el
otro lateral)

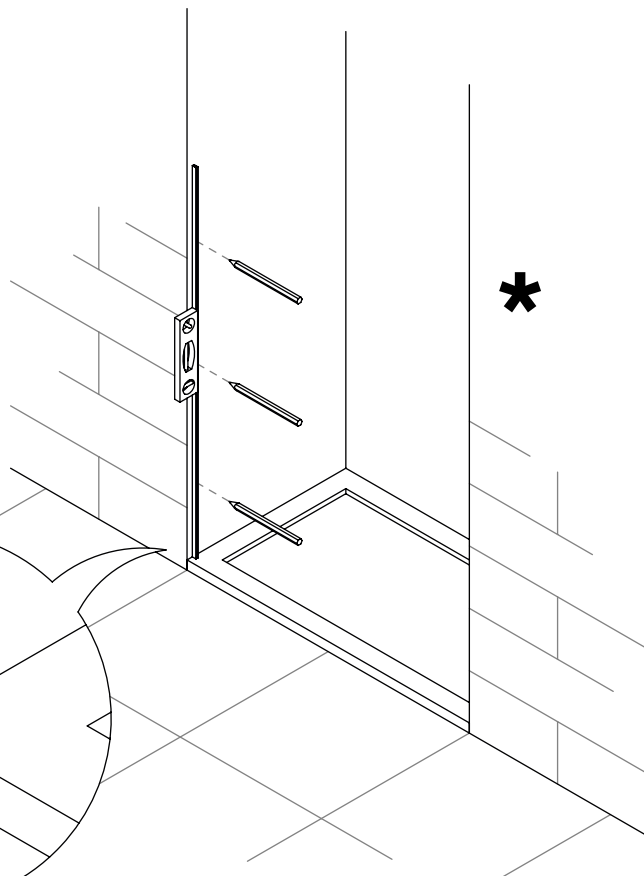
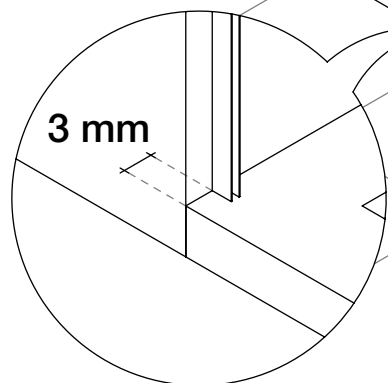

2

taladrar con
broca de Ø 5mm
* (proceder igual
en el otro lateral)

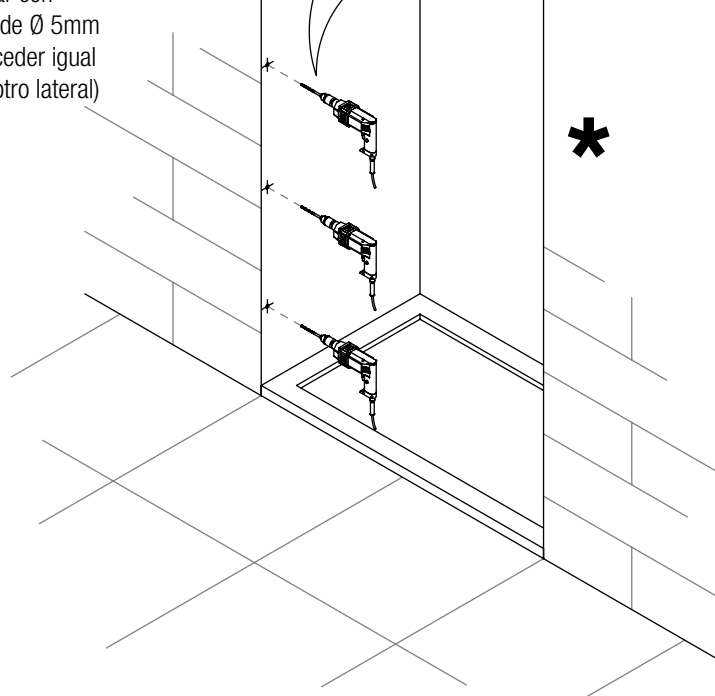
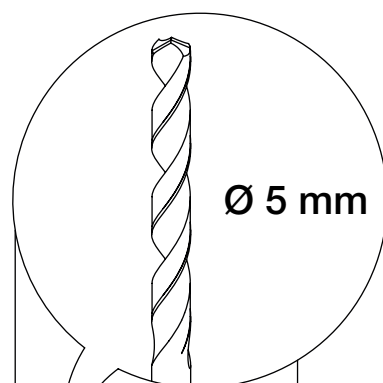

3

atornillar la "U" a pared usando
tacos del nº5 y tornillos 3 x 30
* (proceder igual en el otro
lateral)

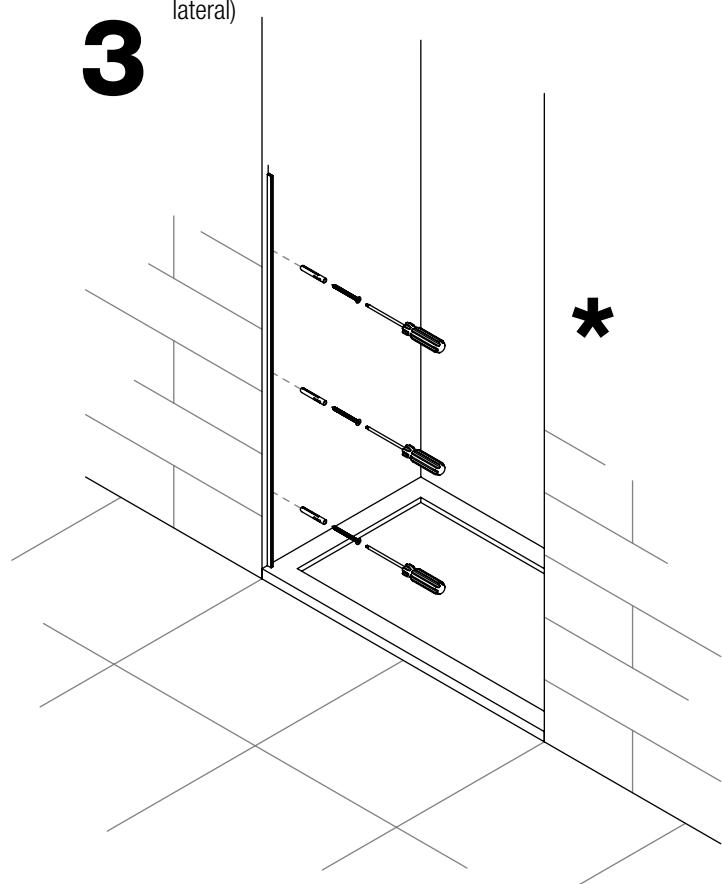

engomar cristal fijo y "U"
y colocar la pinza baja
en el extremo del vidrio

5

4

colocar miniburbujas adhesivas en el plato e introducir los 2 cristales fijos en cada "U" apoyandolo sobre éstas.

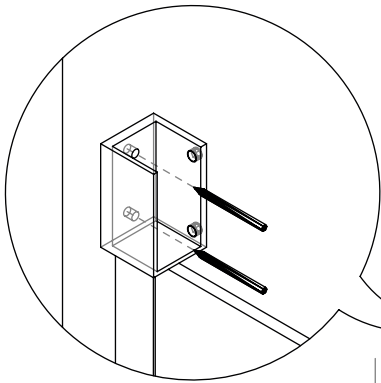

6

presentar guía superior sobre el vidrio fijo, nivelar y marcar los taladros

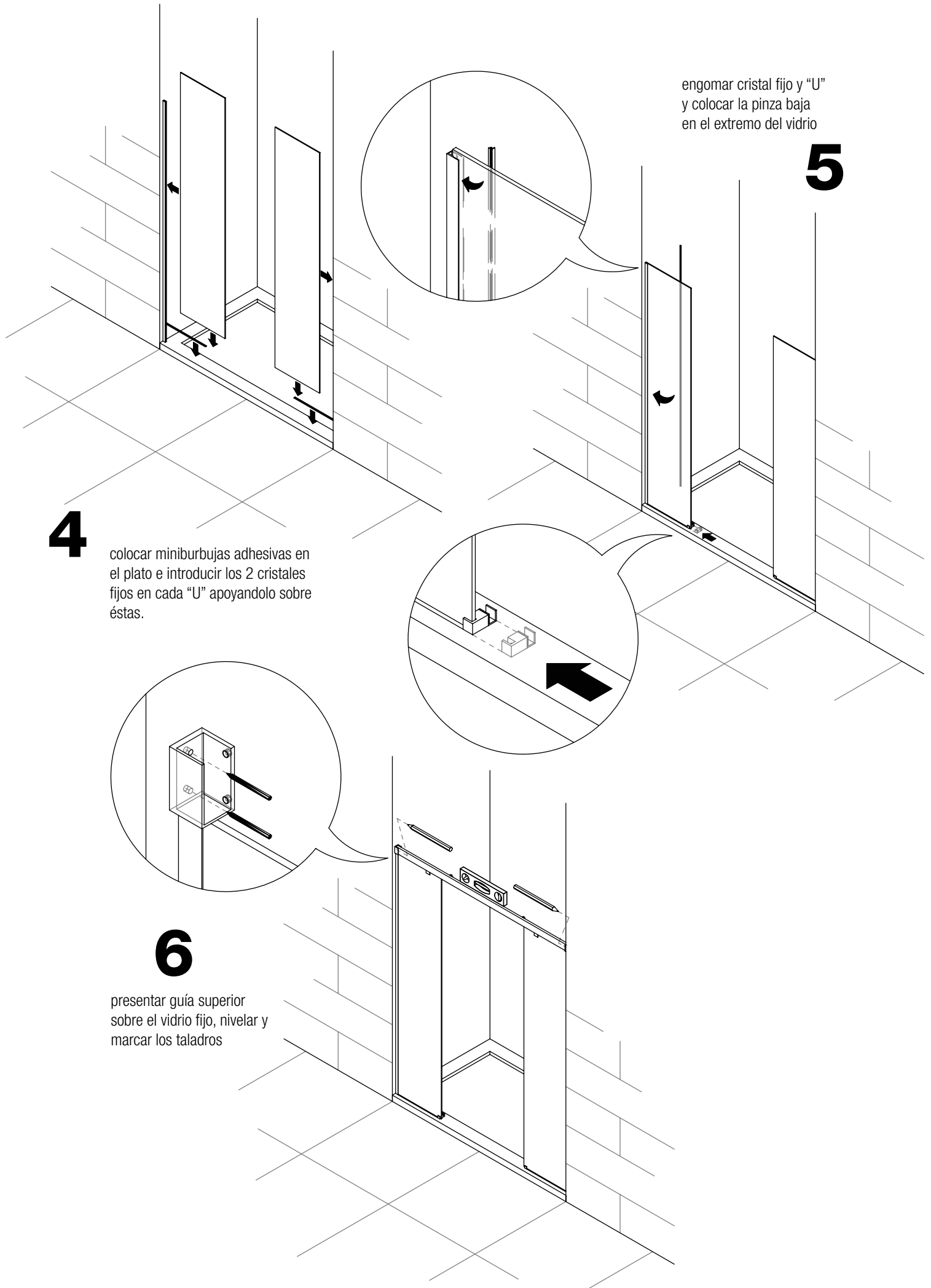
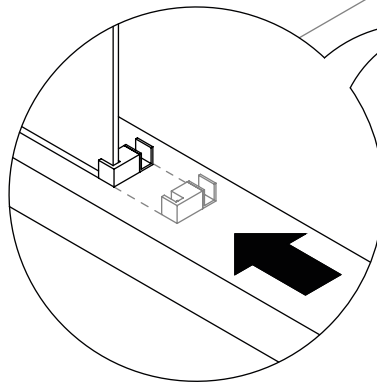

7 taladrar con
broca de \varnothing 6mm

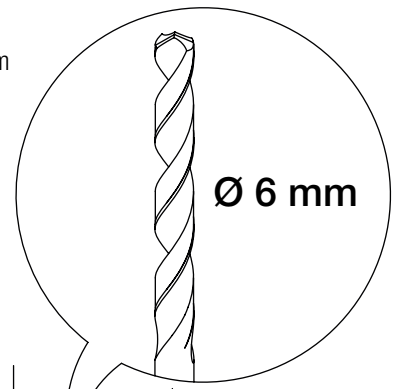

atornillar la guía superior por
medio de las cogidas a pared

8

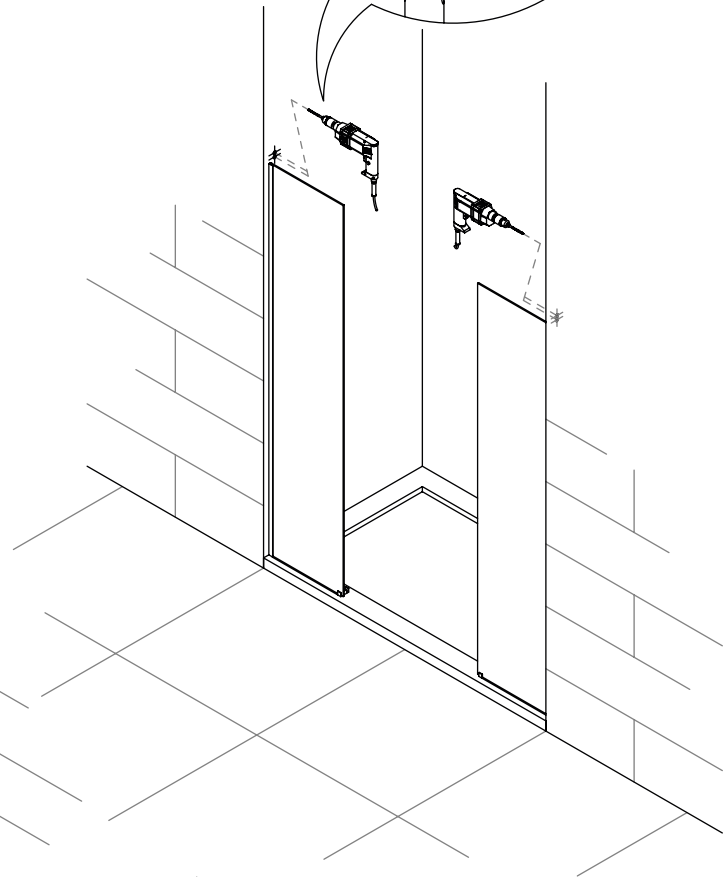
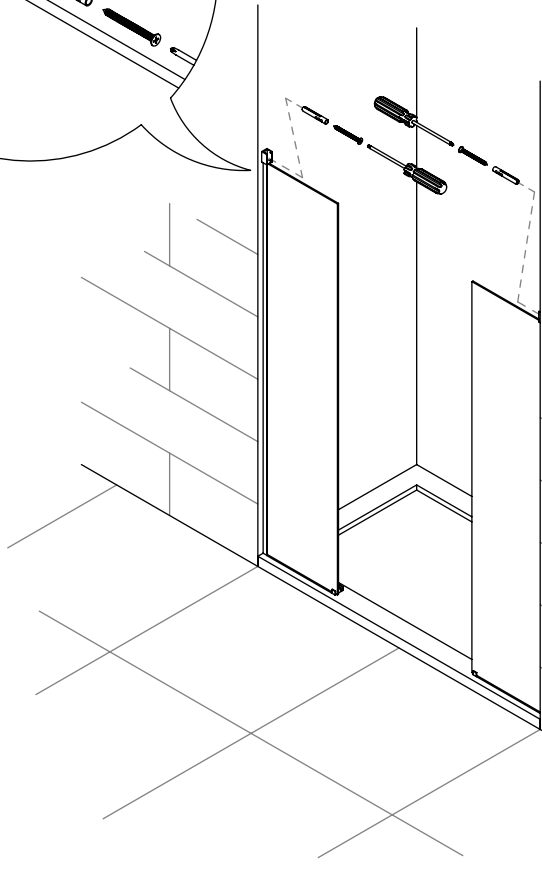
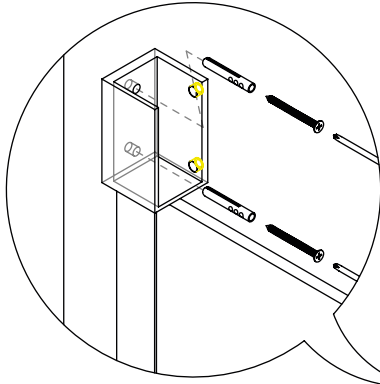

9 colocar la guía superior
en las cogidas a pared

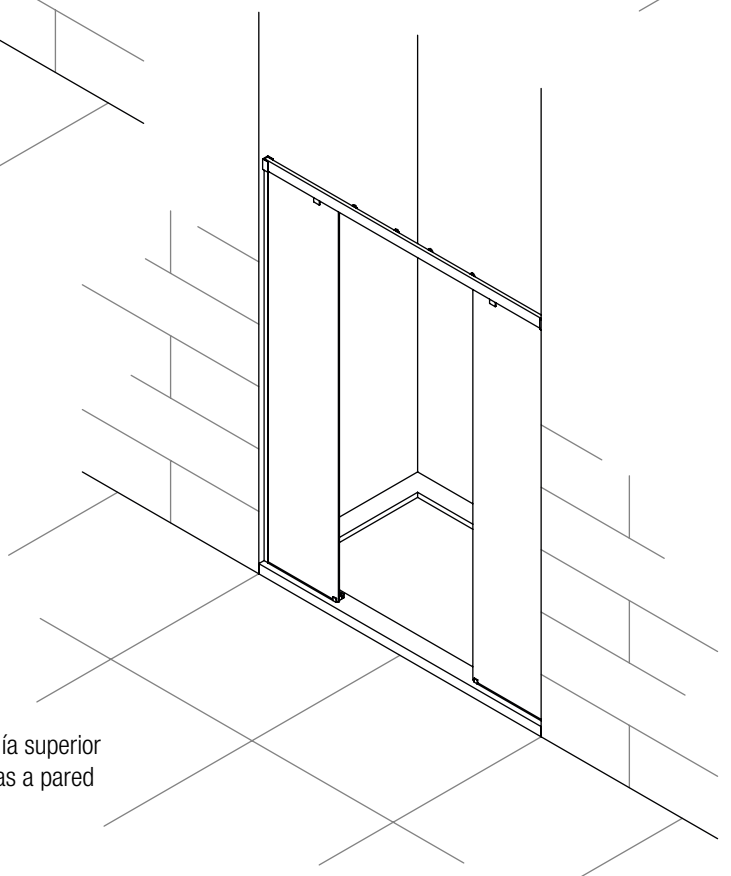

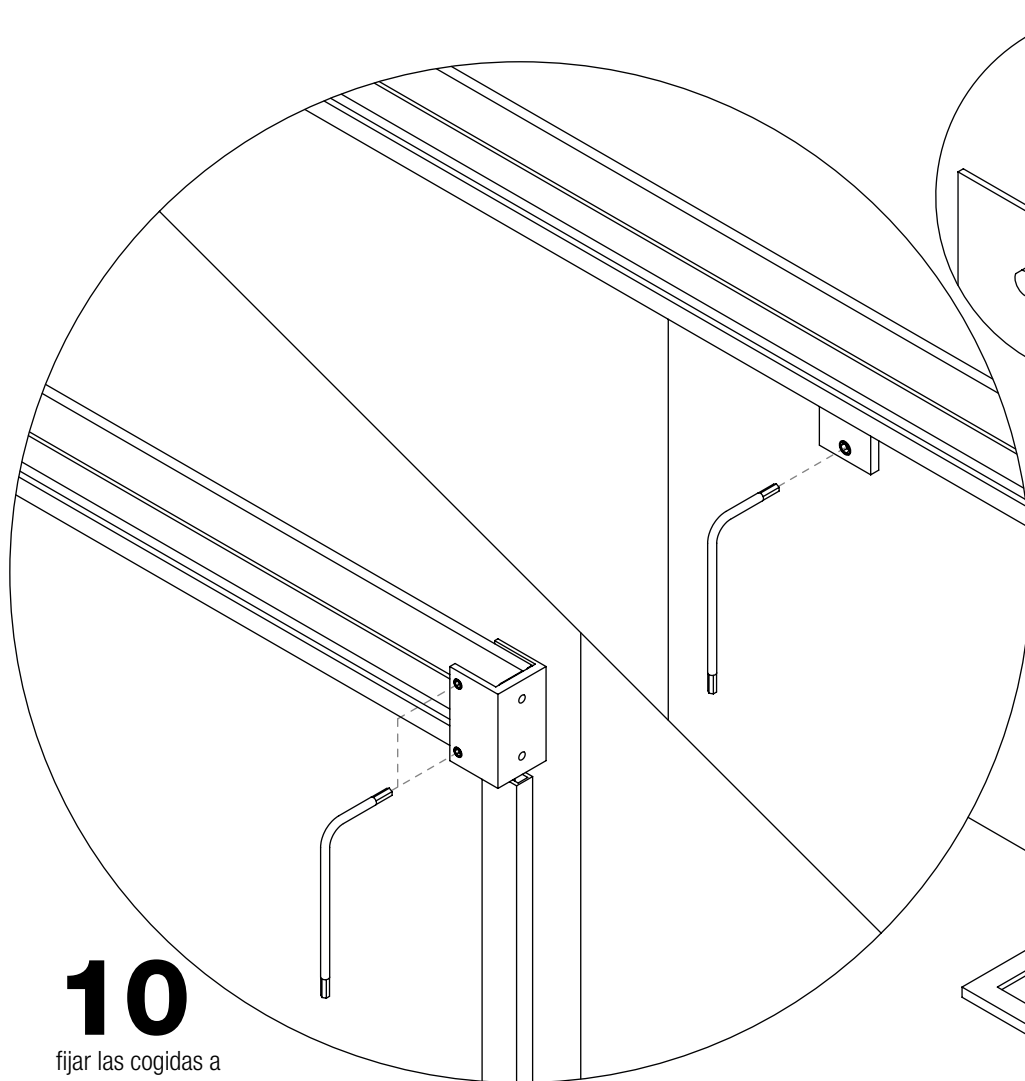

10

fijar las cogidas a la guía y las pinzas superiores mediante los prisioneros

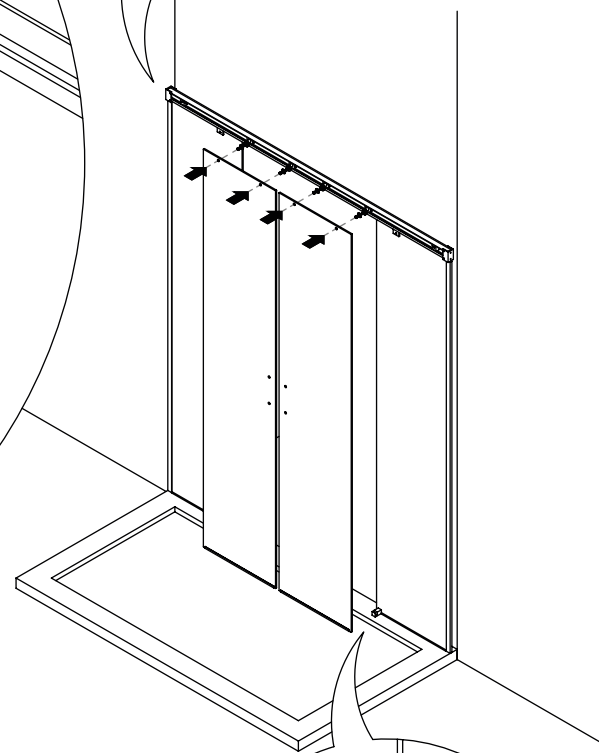

11

colocar la hoja corredera en los rodamientos introduciendo previamente la goma "U" en el canto inferior e insertandolo por la ranura más ancha de la pinza inferior

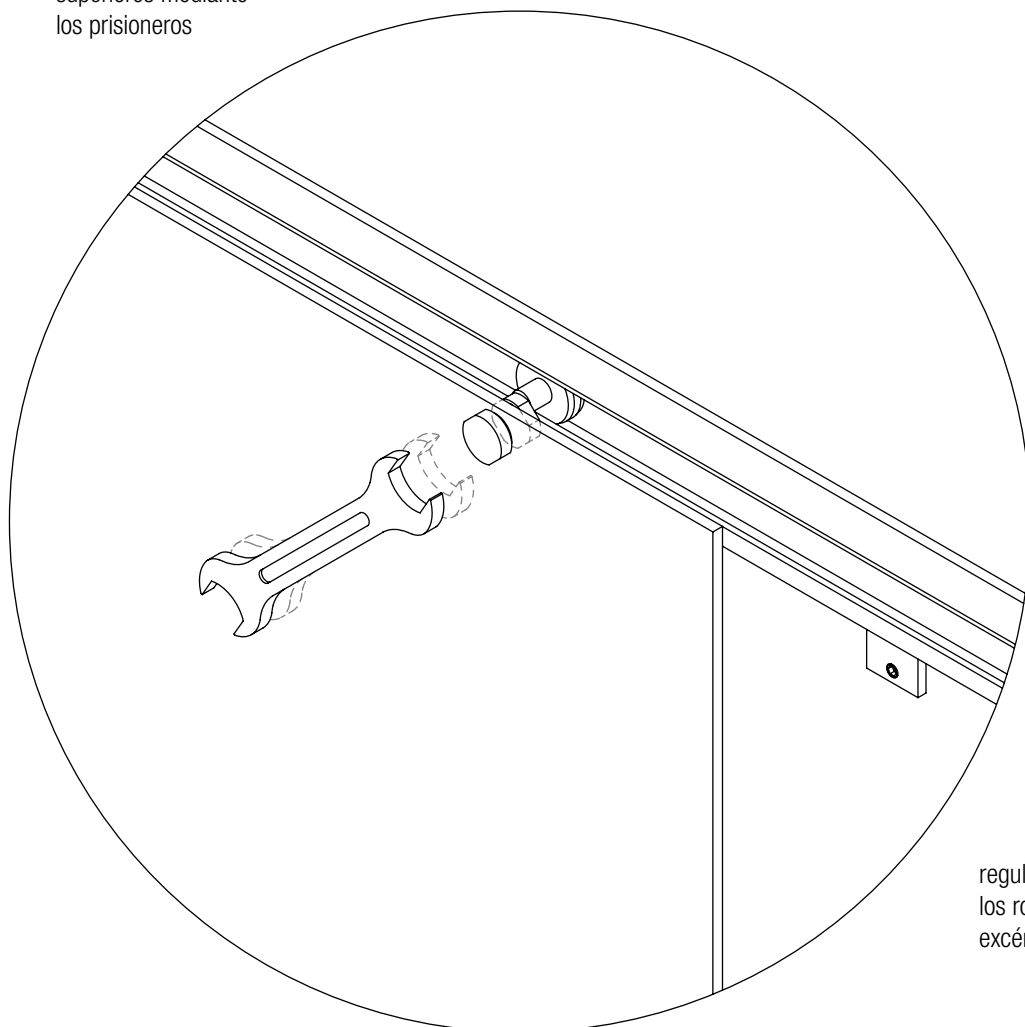

12

regular la hoja mediante los rodamientos excéntricos con 2 llaves

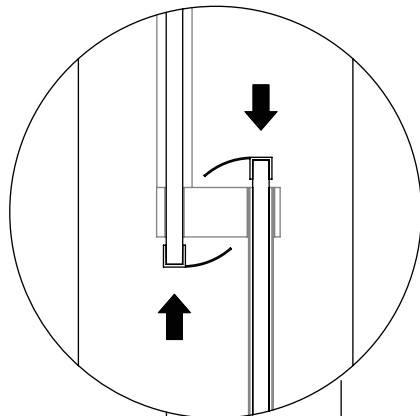

13

colocar las gomas de cruce, una en cada fijo y 2 en la hoja corredera.
colocar el tirador

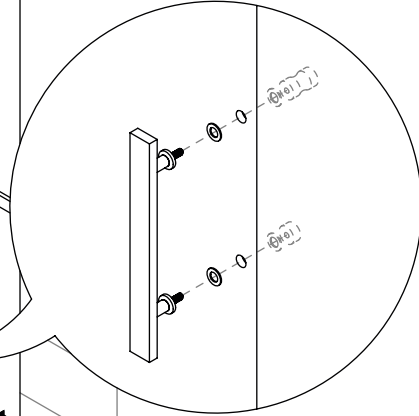

colocar el cierre de imán
en el extremo de las
hojas correderas

14

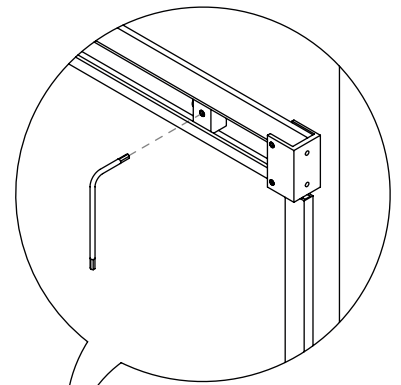

fijar los topes
mediante el prisionero

15

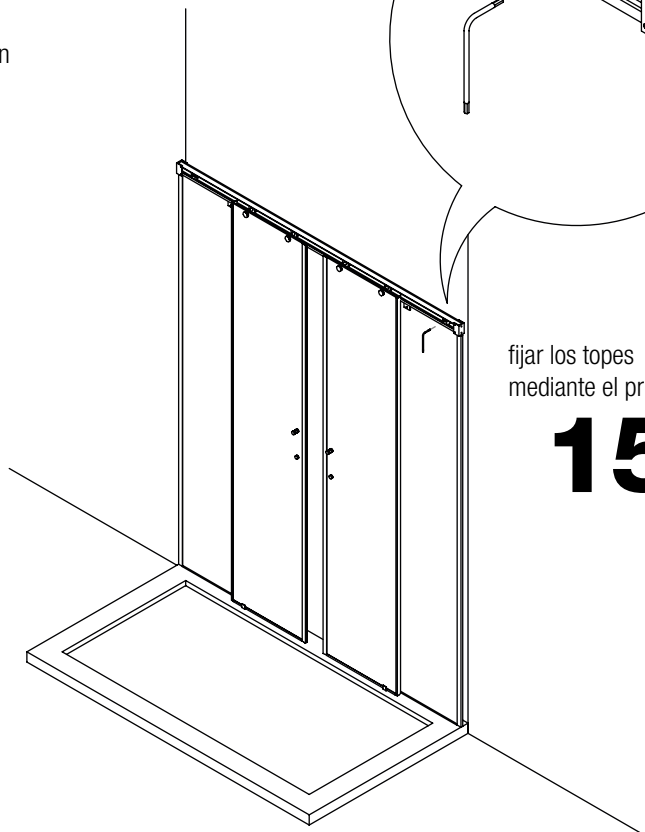

cortar el perfil bajo a medida, entre las dos pinzas bajas y colocar por delante de la hoja corredera

16

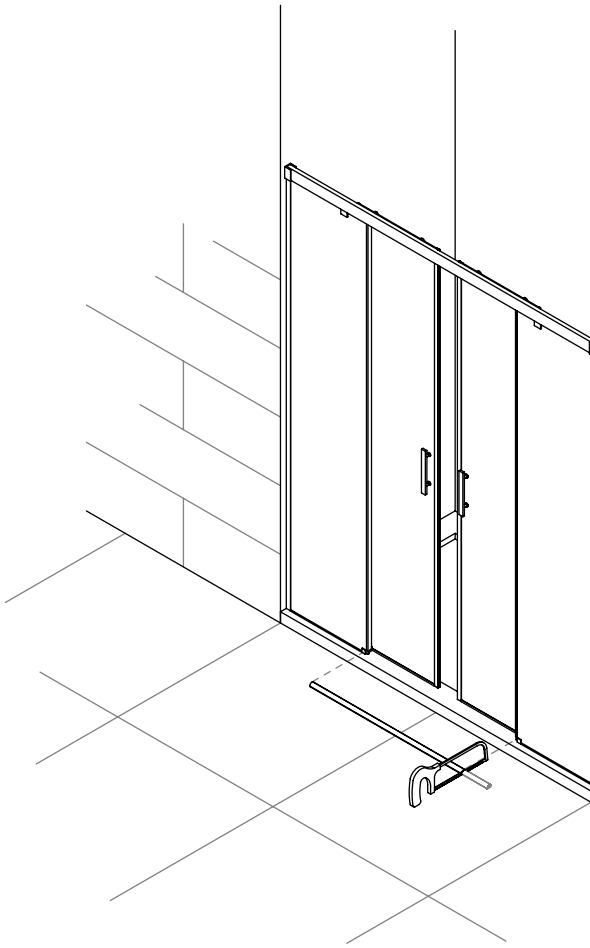

17

sellar perfil bajo con silicona, por delante y por detrás

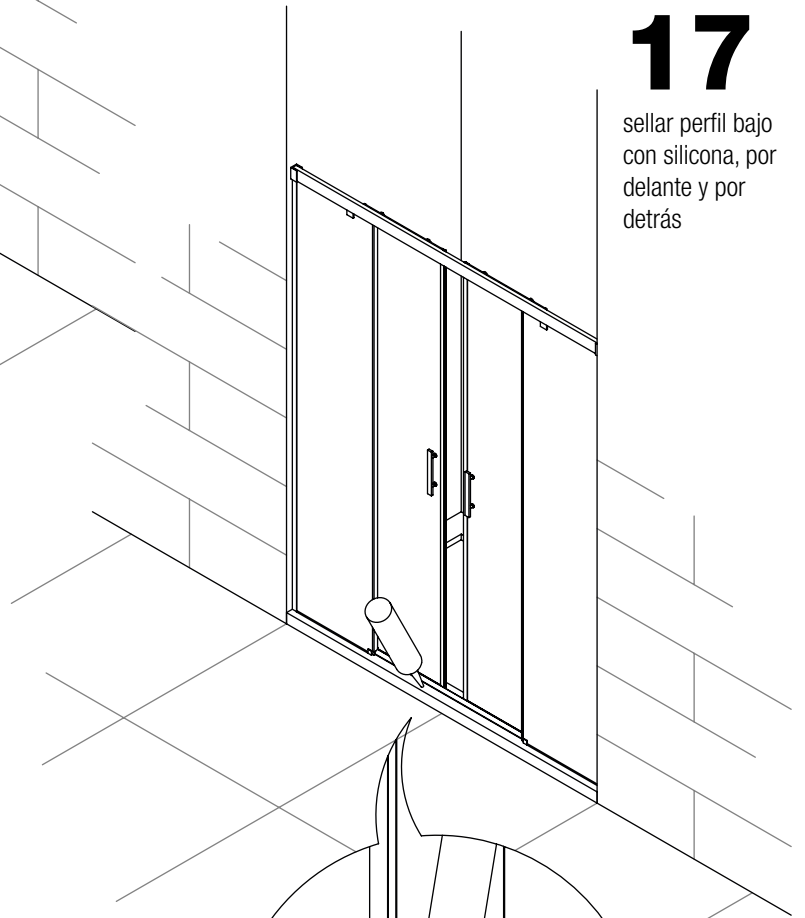

18

sellar con silicona el contorno interior de la mampara

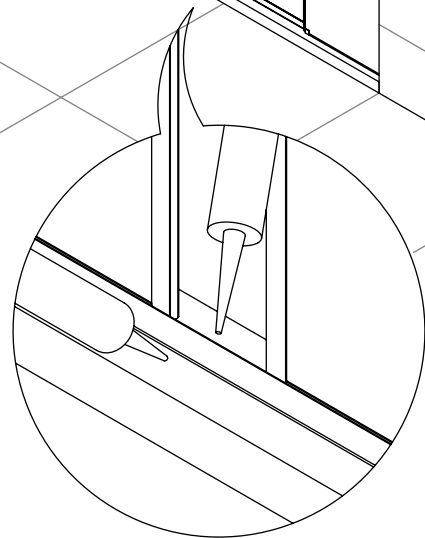
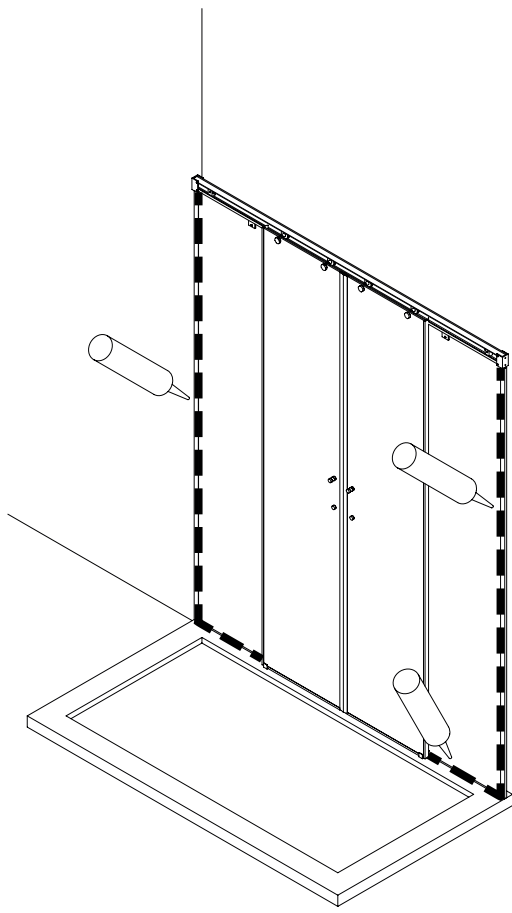

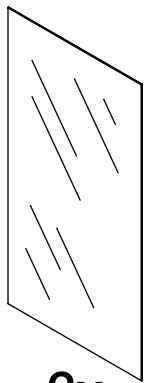
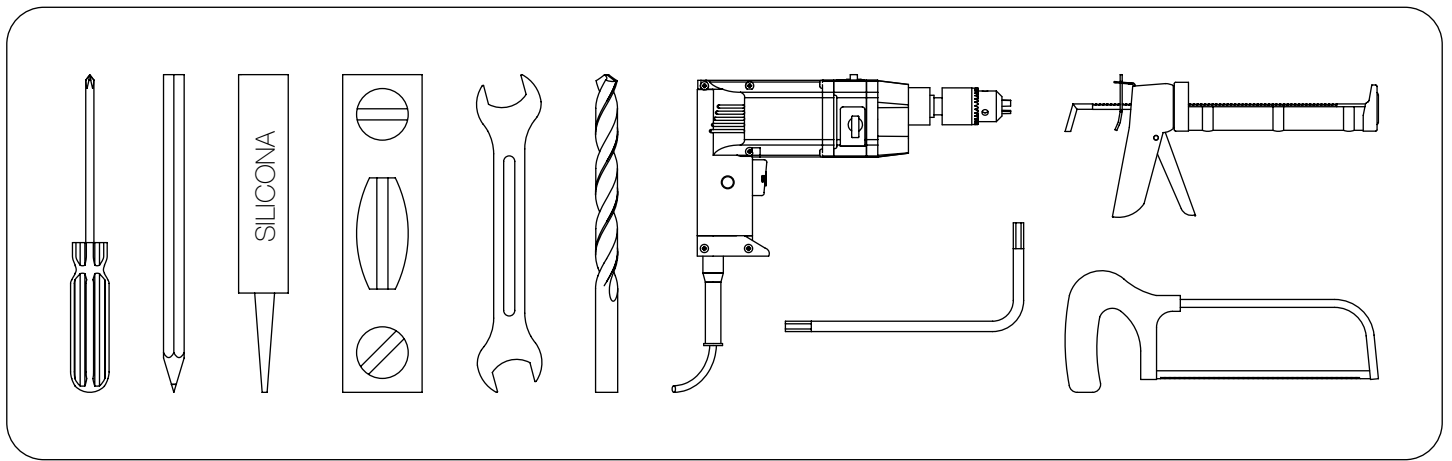

2x
vidrio hoja fija

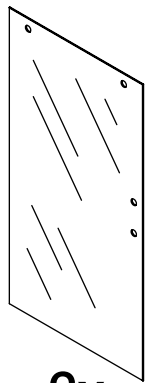

2x
vidrio hoja corredera

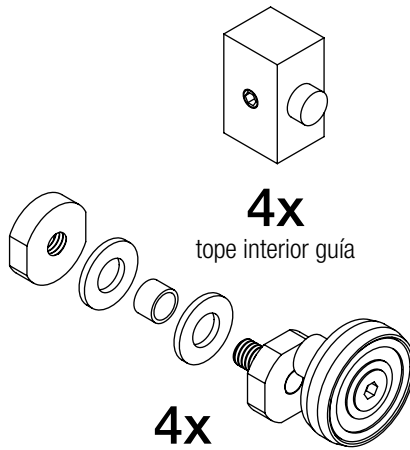

4x
rodamientos de acero inoxidable

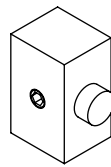

4x
tope interior guía

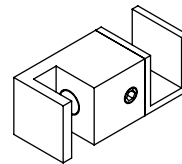

2x
pinza guía inferior

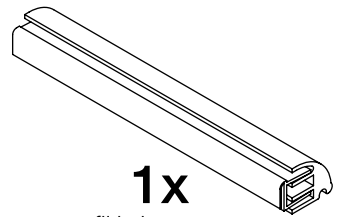

1x
perfil bajo con goma

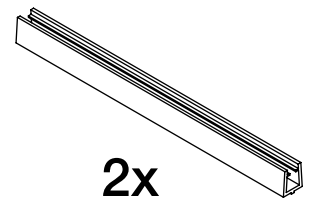

2x
goma "U" inferior hoja corredera

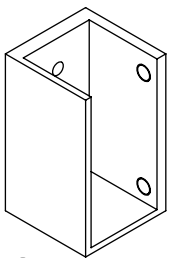

2x
cogidas a pared / guía

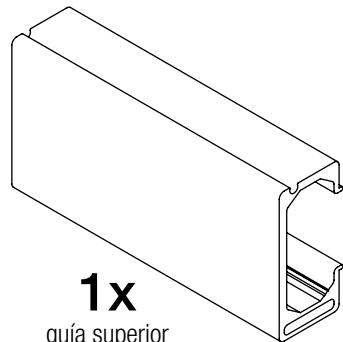

1x
guía superior

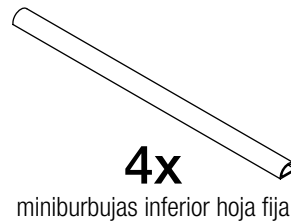

4x
miniburbujas inferior hoja fija



4x
tornillo 4,2 x 32



6x
tornillo 3 x 30



4x
tacos nº6



6x
tacos nº5

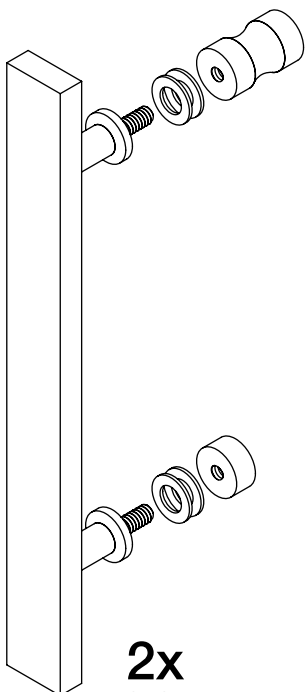

2x
tirador

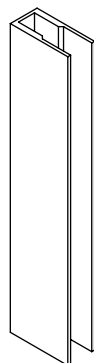

2x
"U" para fijo

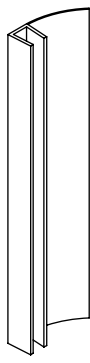

4x
gomas de cruce fijo / corredera



2x
goma fijo / "U"

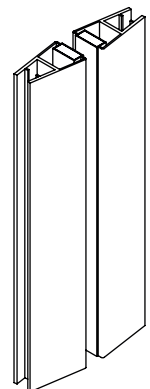

1x
cirrede de imán