

BERNINI

MAMPARA DE DUCHA

ANGULAR 3 HOJAS:
1 CORREDERA + 2 FIJOS

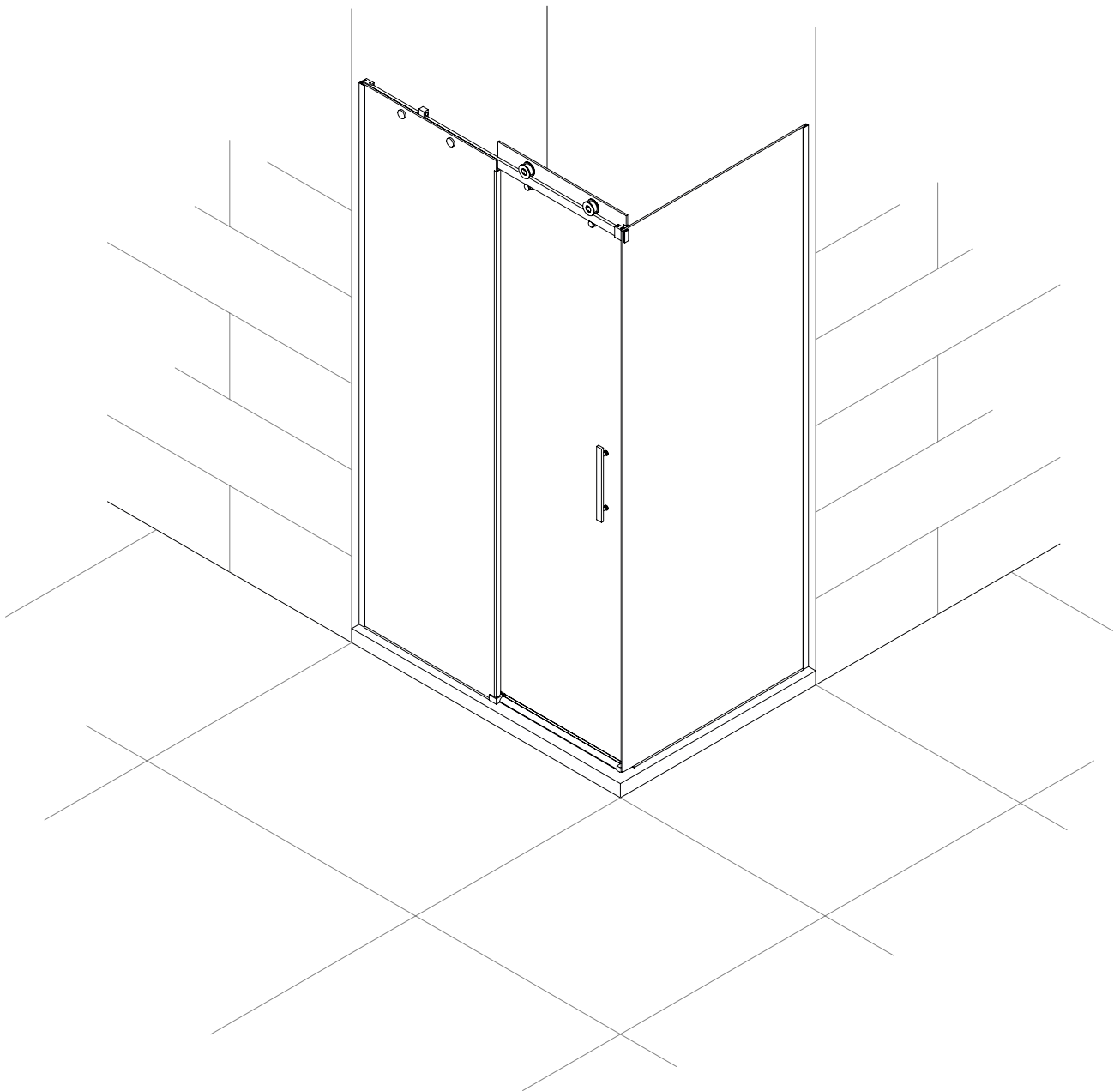

1

presentar "U" en pared
y marcar taladros

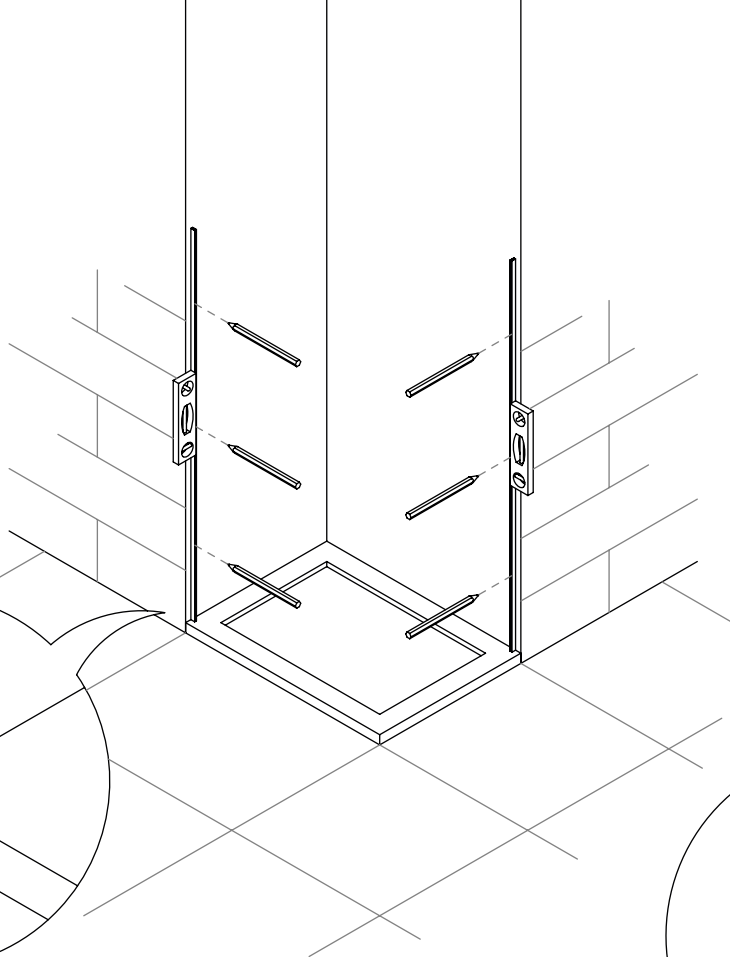
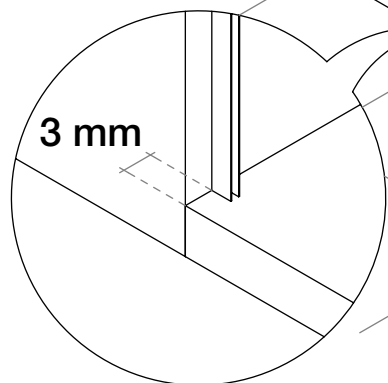

2

taladrar con
broca de Ø 6mm

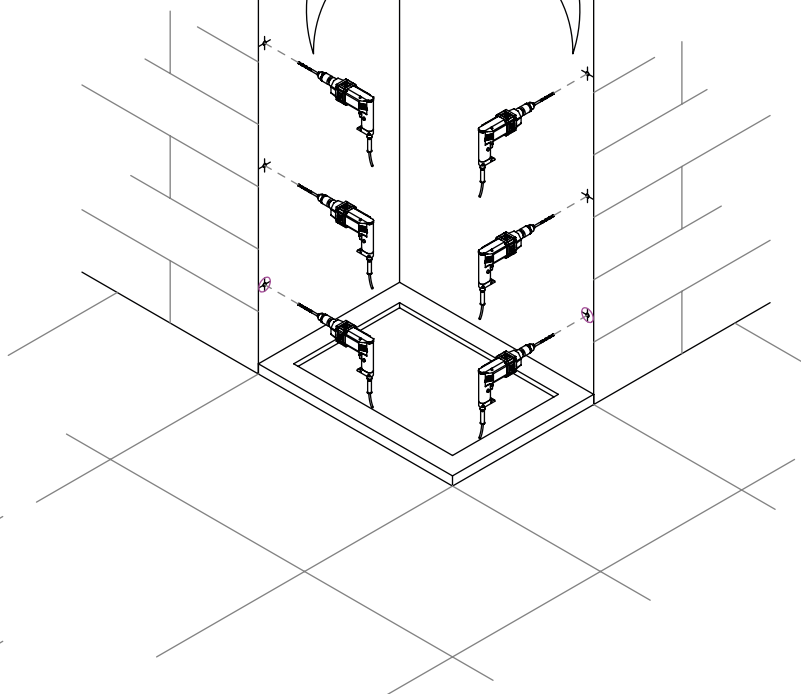
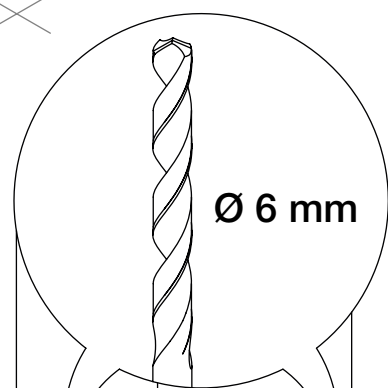

3

atornillar la "U" a pared usando
tacos del nº6 y tornillos 4,2 x 32
en cada lateral

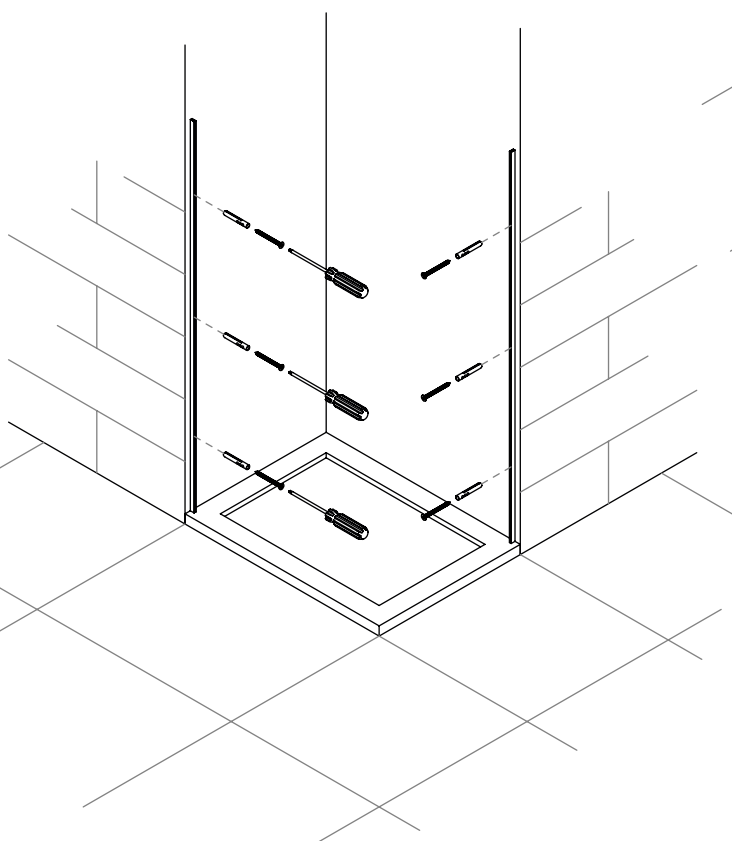

4

colocar miniburbujas adhesivas en el plato e introducir el cristal fijo en la "U" apoyándolo sobre éstas.

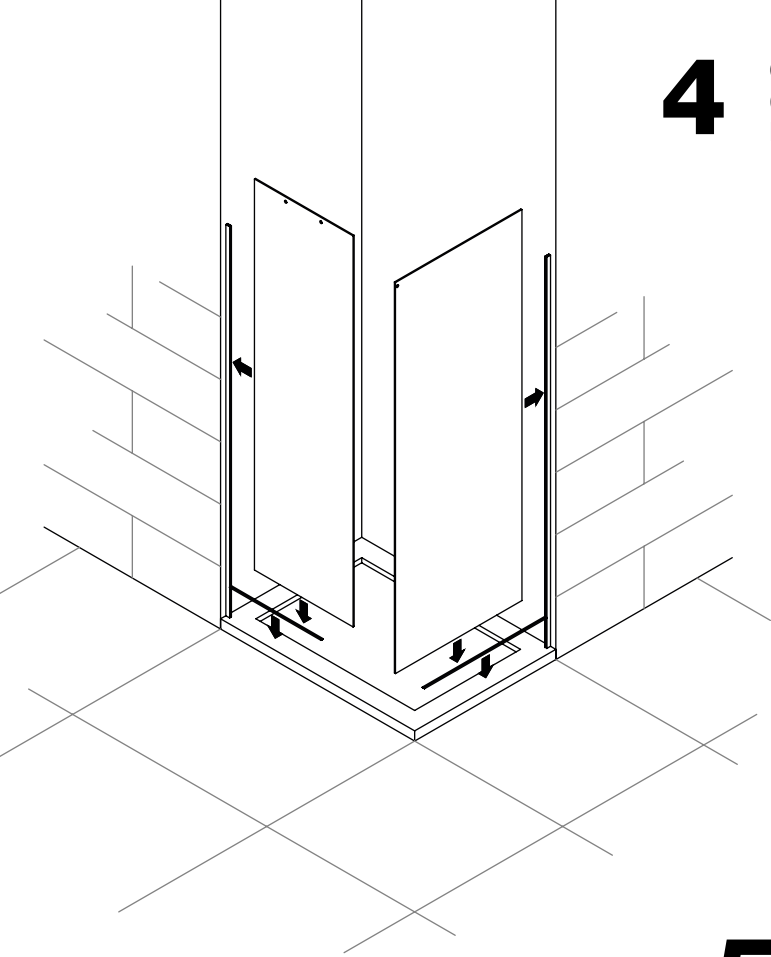

5

engomar cristal fijo y "U" y colocar la pinza baja en el extremo del vidrio

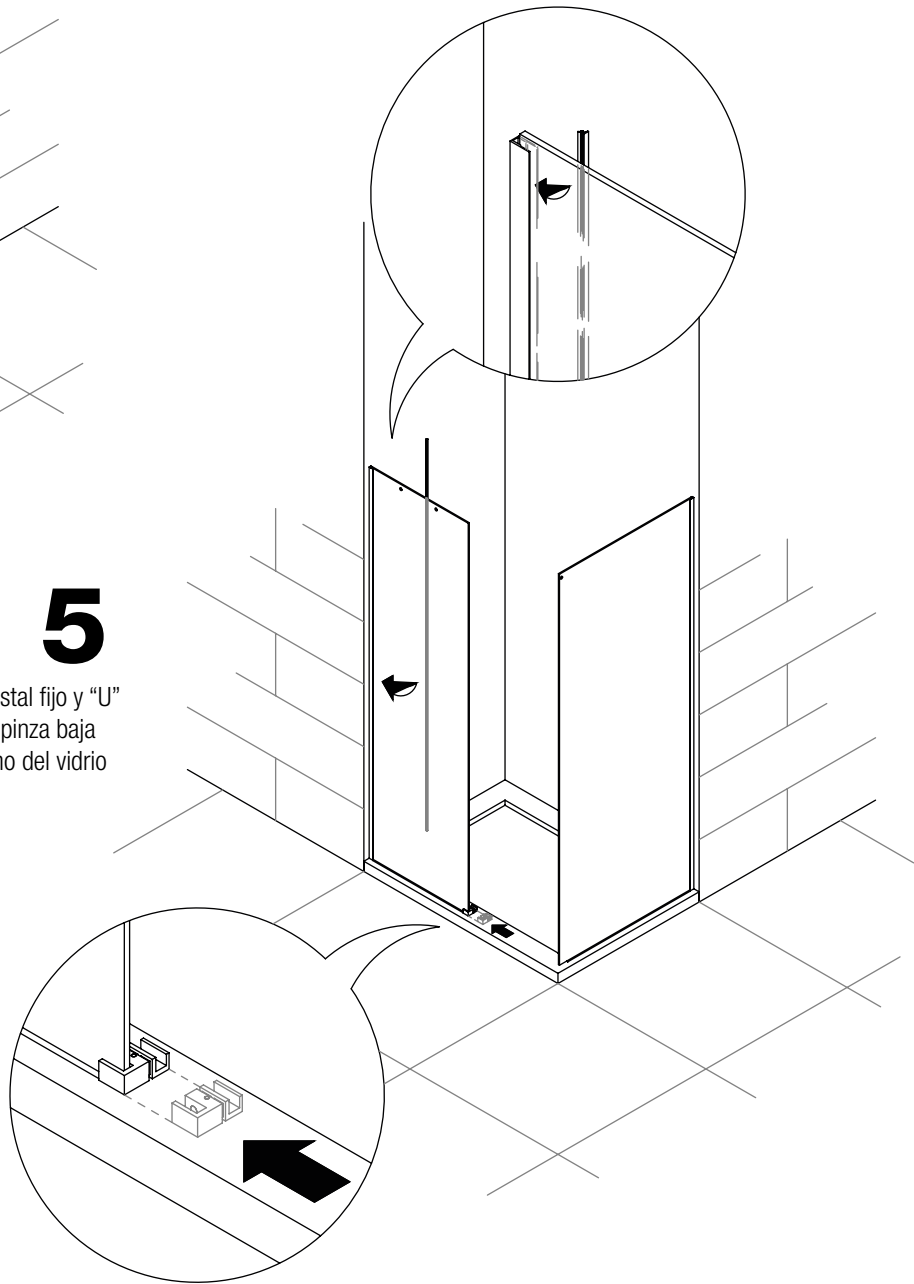

6

unir las dos guías mediante el codo, fijándolas a través de sus prisioneros

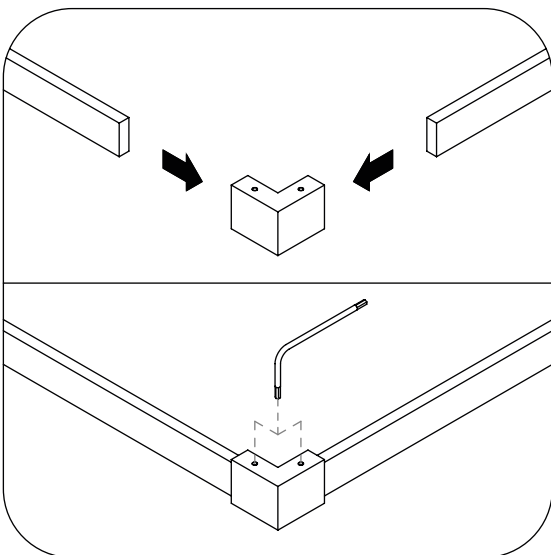

7

presentar guía superior sobre el vidrio fijo, para ello ajustar las cogidas, sin apretarlas, nivelar y marcar los taladros y retirar la guía

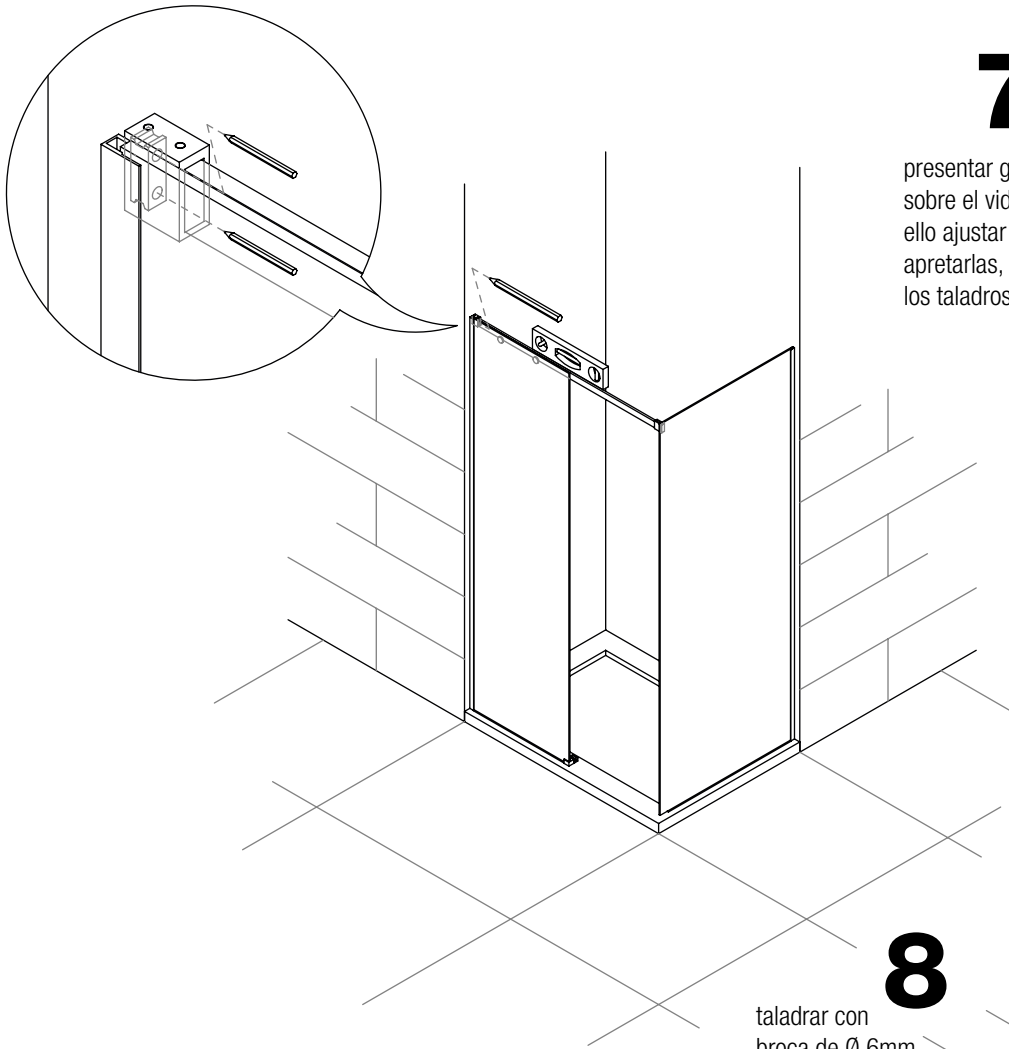

8

taladrar con broca de Ø 6mm

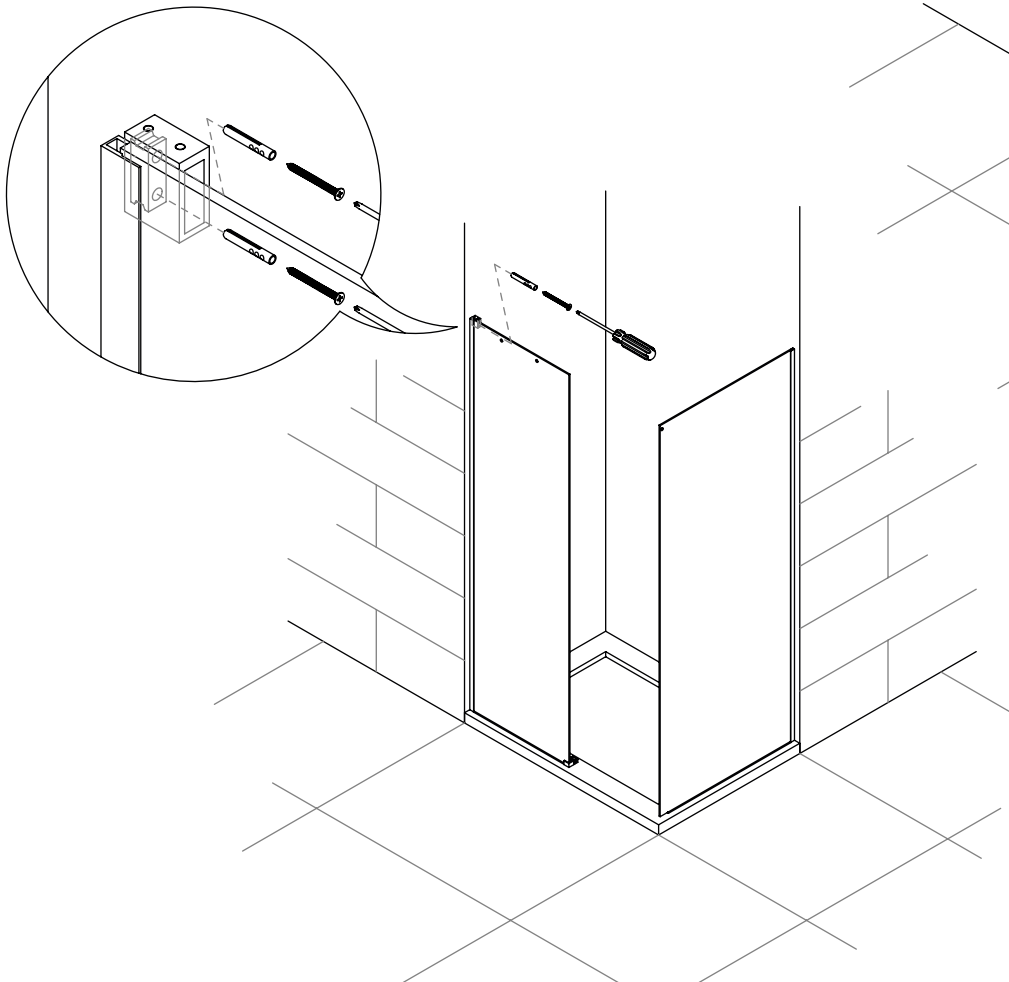
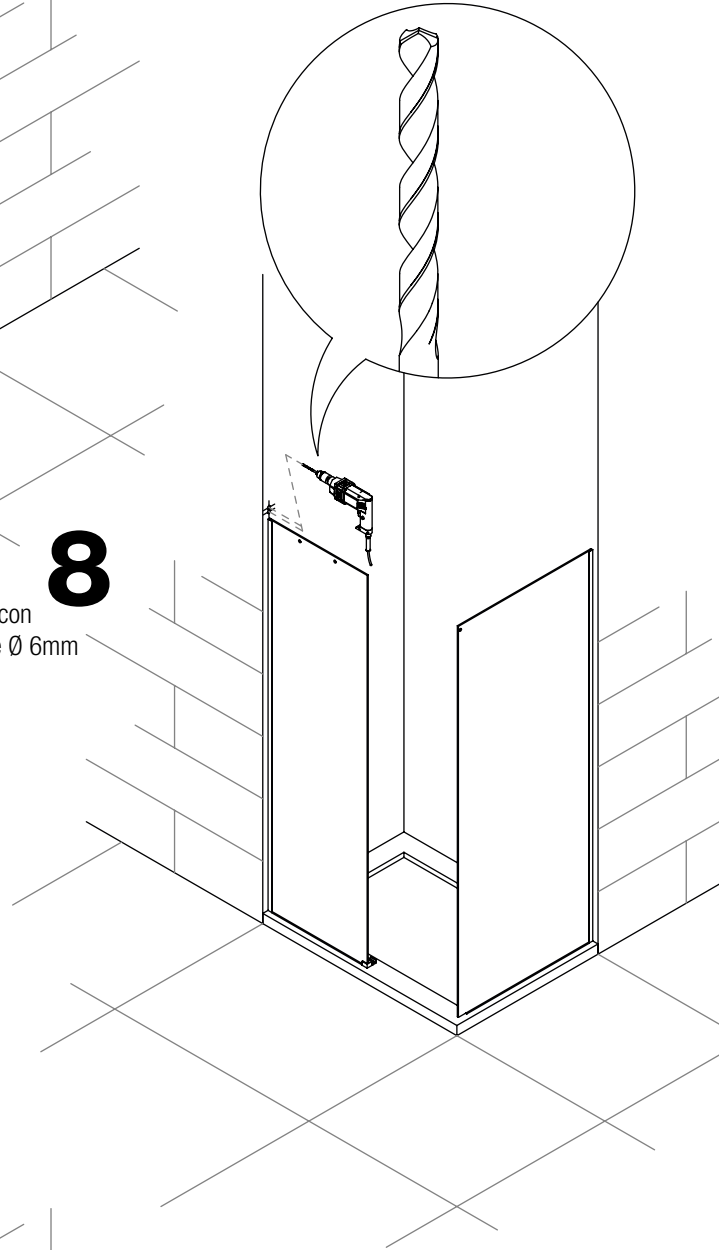

9

atornillar la guía superior por medio de las cogidas a pared

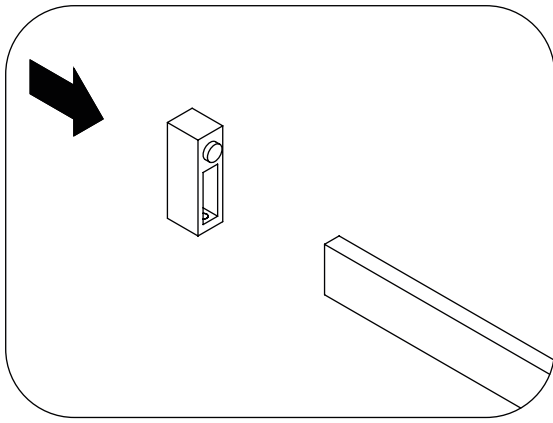

introducir en la guía el tope

10

11

fijar las cogidas al fijo y la guía a las cogidas a pared

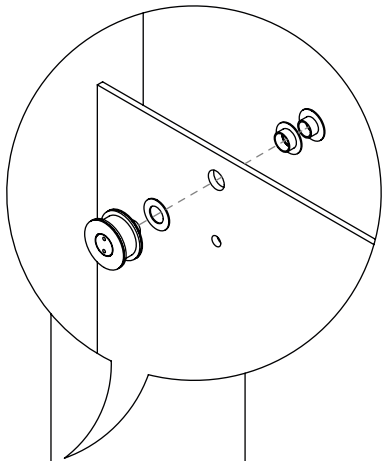
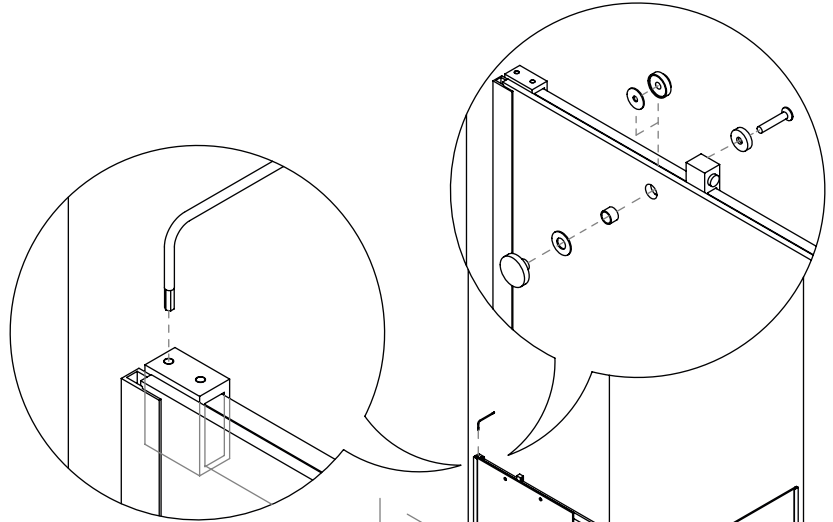

12

regular la hoja mediante los rodamientos excéntricos

13

colocar las gomas de cruce, una en el fijo y otra en la hoja corredera y la goma de burbuja en el extremo de cierre de la hoja corredera

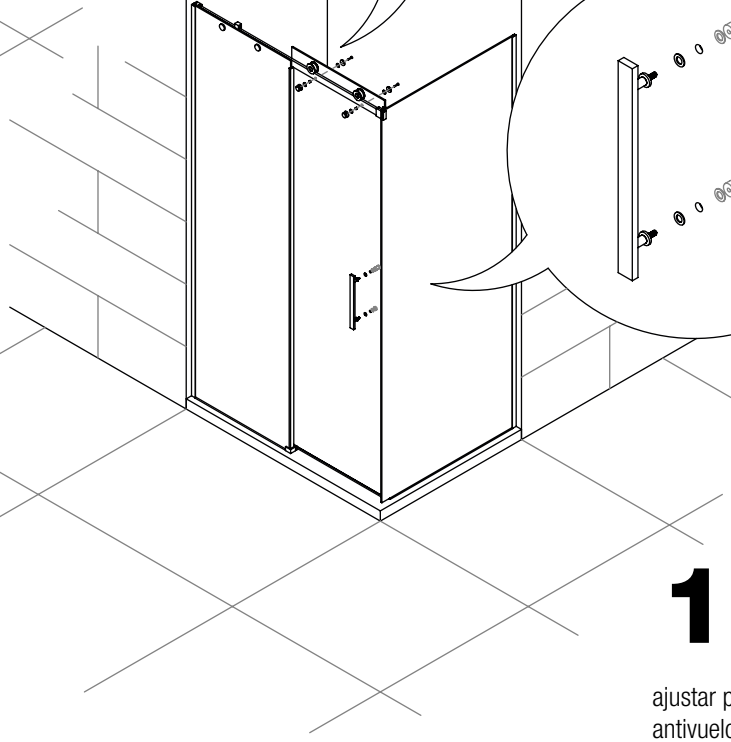
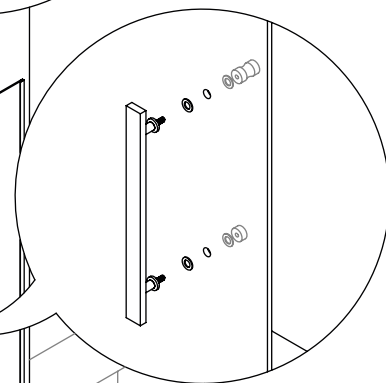
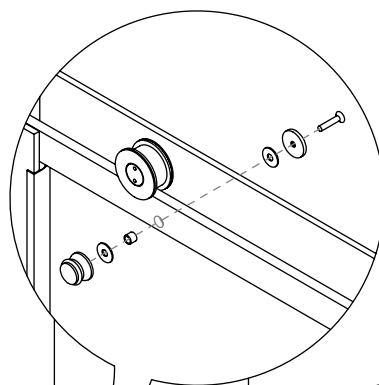
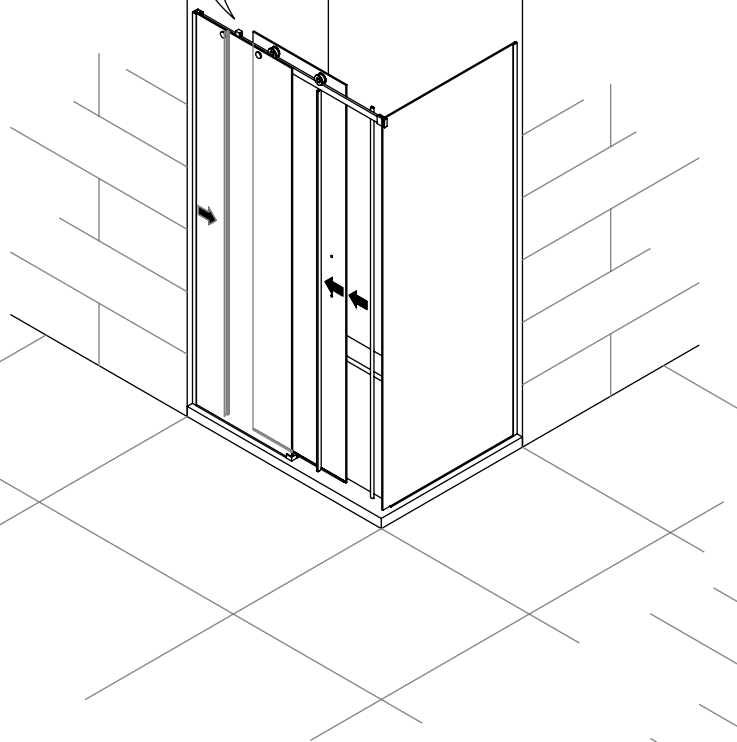
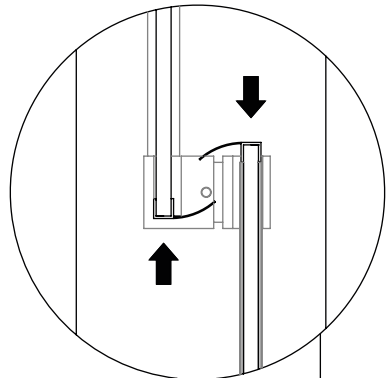

14

ajustar pernos antivuelco y colocar tirador

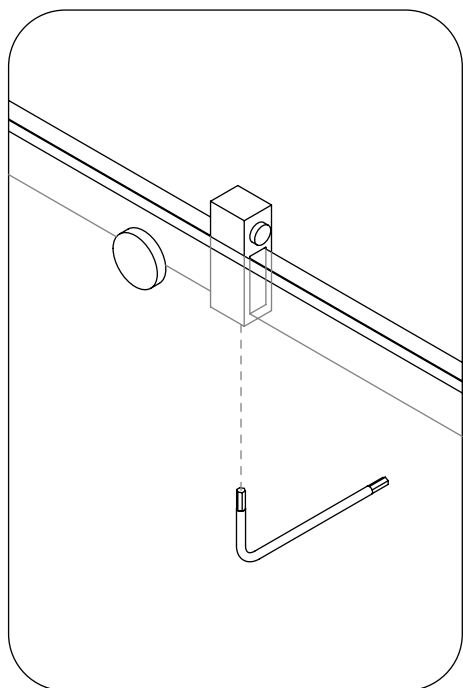

fijar el tope mediante los prisioneros

15

cortar el perfil bajo a medida, desde la pinza baja hasta el otro cristal fijo, colocándole el embellecedor y situar por delante de la hoja corredera

16

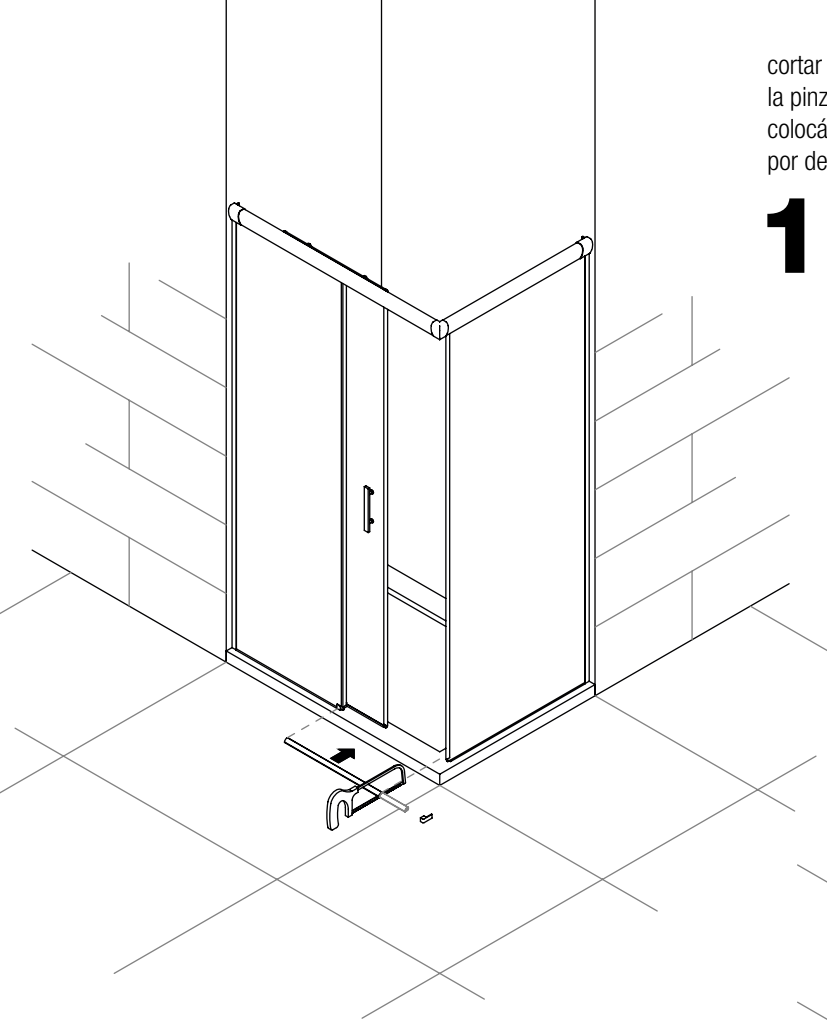

17

sellar perfil bajo con silicona, por delante y por detrás

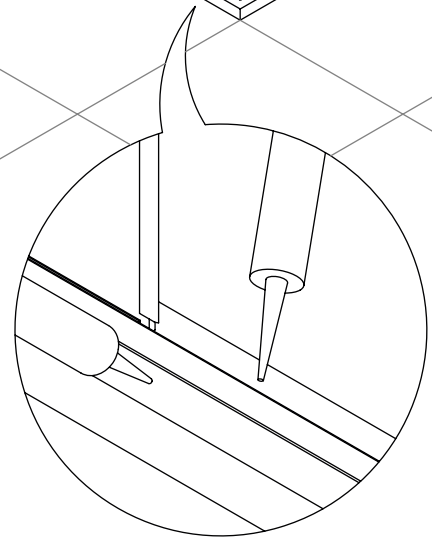
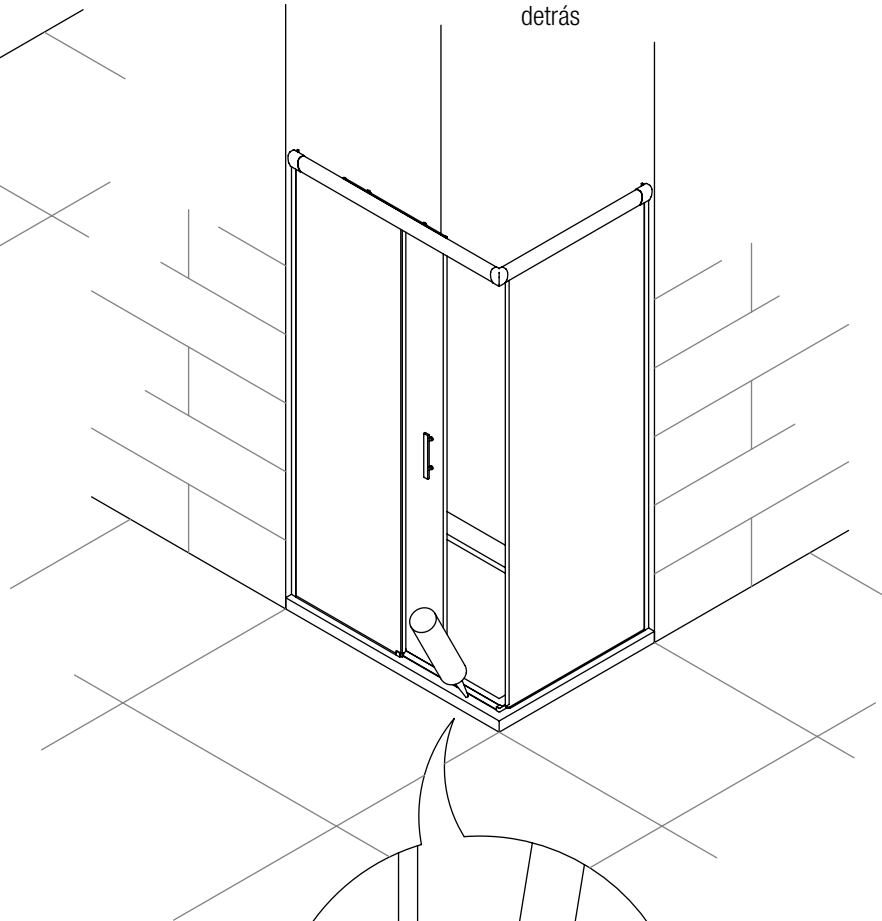

18

sellar con silicona el contorno interior de la mampara

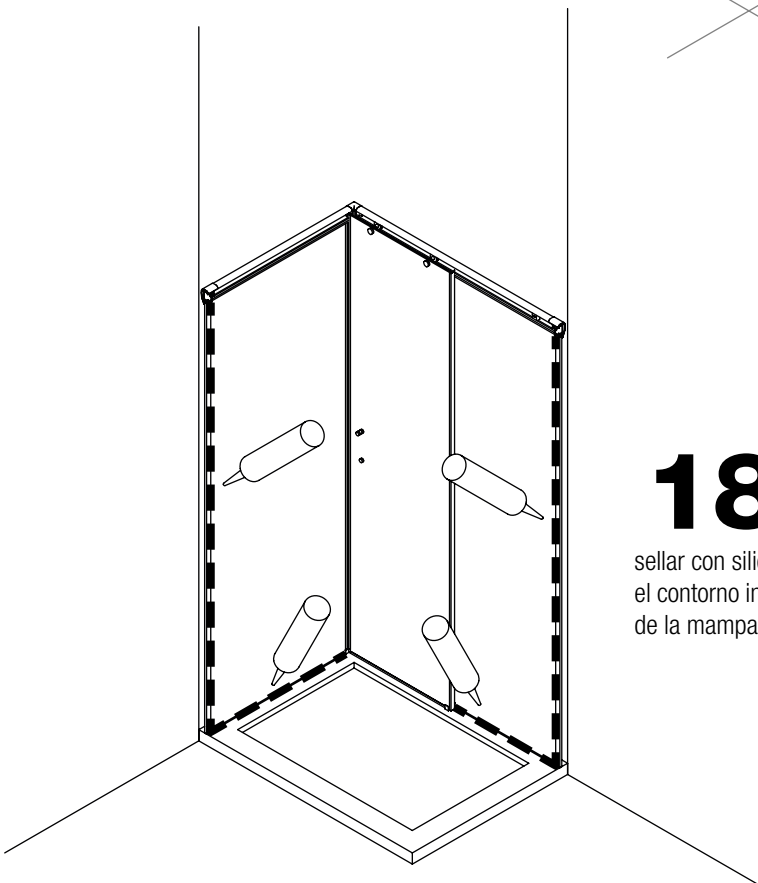

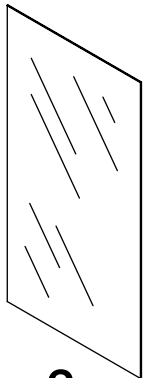
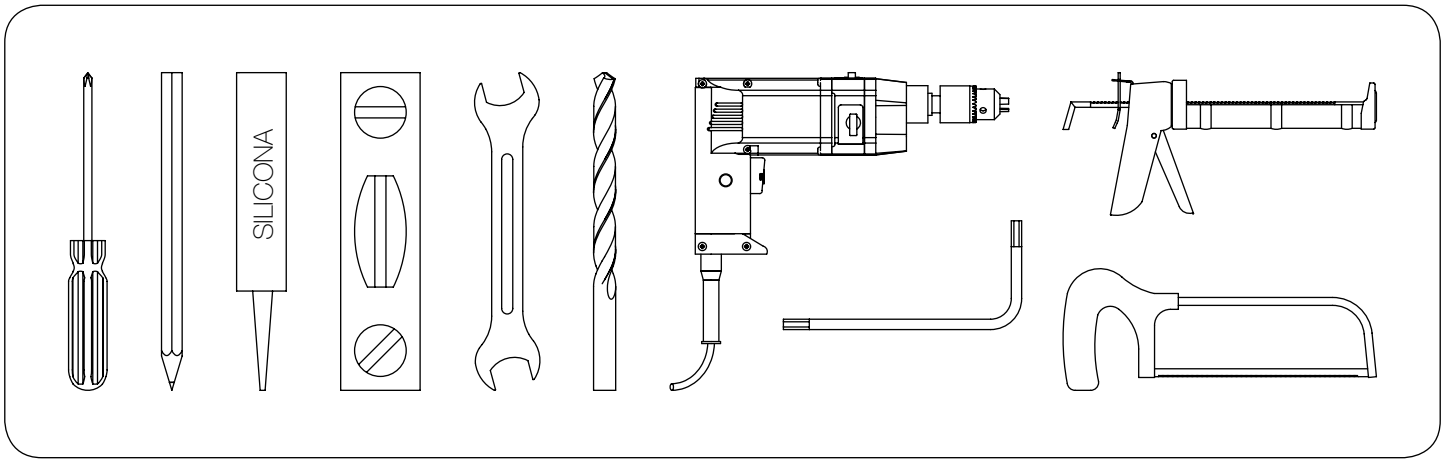

2x
vidrio hoja fija

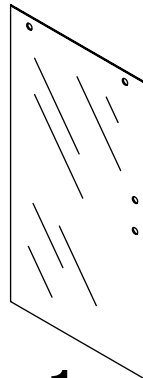

1x
vidrio hoja corredera

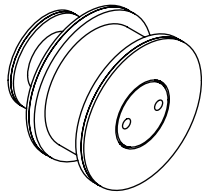

2x
rodamientos de acero
inoxidable

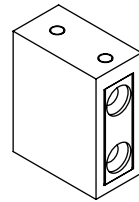

1x
cogidas a pared / guía

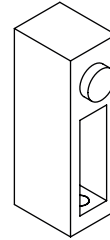

1x
tope interior guía

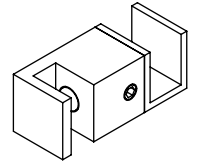

1x
pinza guía inferior

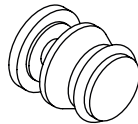

2x
pernos antivuelco

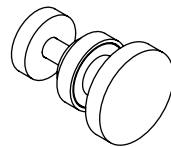

2x
sujeción fijo / guía

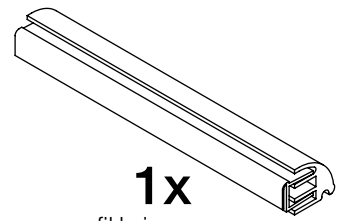

1x
perfil bajo con goma

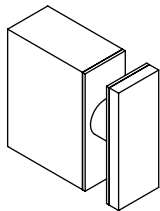

1x
cogida guía / vidrio hoja fija

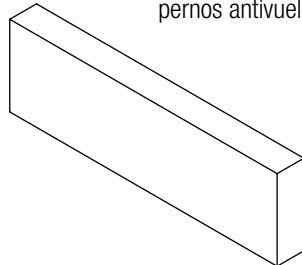

1x
guía superior

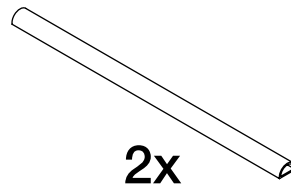

2x
miniburbujas inferior hoja fija

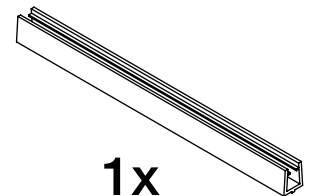

1x
goma "U" inferior hoja corredera

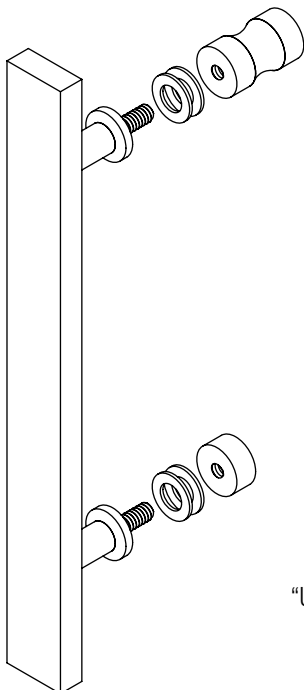

1x
tirador

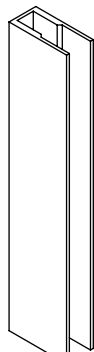

2x
"U" para fijo

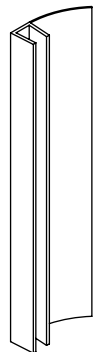

2x
gomas de cruce
fijo / corredera

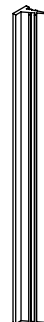

2x
goma fijo / "U"



1x
cierre de burbuja

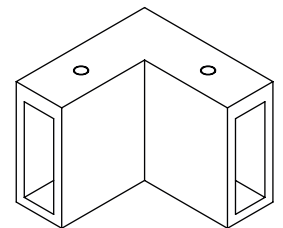

1x
codo unión guía

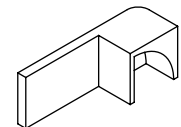

1x
embellecedor perfil bajo



8x
tacos nº6

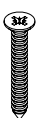

8x
tornillo 4,2 x 32

instrucciones realizadas por:



www.ar3d.es